



# KILSYTH COMMUNITY PLAN

2016 – 2018



be inspired  
have your say  
get involved

**KILSYTH**  
Community Planning  
Group

Creating a happy Kilsyth

[www.kilsythcommunity.wix.com/getinvolved](http://www.kilsythcommunity.wix.com/getinvolved)



## **Welcome to Kilsyth... *this is our Vision***

*Kilsyth is a safe, welcoming, supportive and friendly community nestled at the foot of the Dandenong Ranges, boasting open green spaces, abundant nature and diverse housing. A village where well connected walking paths, cycling tracks, and world class sporting facilities bring pleasure to people of all ages.*

*A place of opportunity, boasting close access to city and country, strong local services, thriving industry, and busy retail precincts.*

For more information about the Kilsyth Community Planning process or to have copies of the Plan sent to you go to:

<http://kilsythcommunity.wix.com/getinvolved>

Or contact:

**Mike O'Meara** Phone: 0412 458 551  
Email: [kilome@bigpond.com](mailto:kilome@bigpond.com)

**Shelley Large** Phone: 0421 615 943  
Email: [mal.shelley@bigpond.com](mailto:mal.shelley@bigpond.com)

**The Kilsyth  
Community  
Planning  
Committee** Email: [kilsythcommunity@gmail.com](mailto:kilsythcommunity@gmail.com)



be inspired  
have your say  
get involved

**KILSYTH**  
Community Planning  
Group  
Creating a happy Kilsyth

[www.kilsythcommunity.wix.com/getinvolved](http://www.kilsythcommunity.wix.com/getinvolved)

## Contents

TABLE OF CONTENTS .....	4
ACKNOWLEDGEMENTS.....	7
OVERVIEW .....	8
MAP OF KILSYTH .....	9
OVERVIEW .....	9
INTRODUCTION .....	10
Why do we need a Plan? .....	10
What Community Planning is not.....	10
THE KILSYTH CONTEXT.....	11
Representatives of the Community of Kilsyth.....	11
Art Projects .....	11
Safety.....	11
Traffic.....	11
Partnerships.....	11
Communication .....	12
Amenities.....	12
Clean-ups .....	12
Adopt a Spot: The Great Wall of Kilsyth.....	13
Friends of Elizabeth Bridge Reserve .....	13
The Story of Elizabeth Bridge Reserve.....	16
A Kilsyth History.....	17
KILSYTH IN PROFILE .....	19
The Kilsyth Environment.....	19
Locality Overview .....	19
Environmental Characteristics.....	19
Transport Options.....	19
Commercial Features.....	20
Community Services .....	20
Demographics.....	21
Who Lives Here.....	21
Population .....	21
Marital Status / Family Composition .....	22
Employment .....	24
Education.....	26

Housing.....	26
ENGAGING THE KILSYTH COMMUNITY – HOW WE WENT ABOUT IT .....	27
CONSULTATIONS – WHAT WE LEARNED .....	31
Themes .....	31
Communications.....	32
Vulnerable Groups.....	32
Older People .....	32
Community Identity.....	32
Sport and Recreation.....	33
Young People .....	33
STRATEGIES AND ACTIONS .....	34
KILSYTH COMMON AND TOWN CENTRE PROJECT.....	34
OFF LEASH DOG PARK.....	35
THE CHELODINA FESTIVAL.....	35
KILSYTH WALK.....	36
KILSYTH COMMUNITY ACTION PLAN.....	37
Kilsyth Common & Town Centre Project .....	37
Kilsyth Walk .....	39
The Chelodina Festival.....	41
Kilsyth Off Leash Dog Park.....	43
Appendix 1: THE KILSYTH COMMUNITY PLAN BIG IDEAS REGISTER .....	44
Appendix 2: AN INVENTORY OF IDEAS .....	50
Kilsyth Common and Town Centre Project.....	50
Walking Map of Kilsyth’s Treasures.....	50
Off Lead Area for Dogs .....	51
Footpaths.....	52
Community Market .....	52
Kilsyth Community Festival & Trade and Sports Expo.....	53
Appendix 3: SUMMARY OF COMMUNITY SERVICES .....	54
Japara Living & Learning Centre .....	54
Sport and Recreation Facilities .....	55
Pinks Reserve Precinct.....	55
Kilsyth Football Club .....	55
Kilsyth Cricket Club .....	55
Lillydale & Yarra Valley Netball Association .....	56
Kilsyth Sports Centre .....	56
The Kilsyth and Mountain District Basketball Association Inc.....	56



Lilydale Ejays Softball Club .....	57
Kilsyth Centenary Pool.....	57
Aged Care Facilities.....	57
Appendix 4: KILSYTH OFF-LEASH DOG PARK PROJECT PLANNING .....	58
Appendix 5: URBAN DESIGN CONCEPTS.....	59
Appendix 6: KILSYTH COMMUNITY SURVEY SUMMARY .....	62
Appendix 7: SHOPPING PRECINCT TRADER ENGAGEMENT SUMMARY.....	66
Process.....	66
Purpose.....	66
Summarised feedback .....	66
Appendix 8: REFERENCES & FURTHER READING.....	67



## ACKNOWLEDGEMENTS

To achieve objectives that will be owned and supported by the local community, the community planning process must embrace broadly representative voices, each of which brings its own perspective of how we want our community to look, and helps to shape the ultimate outcome.

In Kilsyth, we were fortunate to have an enthusiastic and committed group of people and individuals who brought their interests and concerns to the table. They were not only willing to present their views, but also to seek opinions and observations from others who share Kilsyth with them.

Thanks to everyone who helped create this plan. With support from Yarra Ranges Council officers in conducting community consultation and preparing the planning document, the following contributed to its development:

- The Kilsyth Community Planning Group
- Kilsyth Community members who offered ideas, feedback and support
- Representatives from local small business
- Council officers
- Churinga Village Shopping Centre Management
- Circus Ruccis
- Councillor Len Cox
- Friends of Elizabeth Bridge Reserve
- Gladesville Primary School
- Japara Living & Learning Centre
- Kaycee's Academy of Dance
- Kilsyth Football Club, Senior and Junior
- Kilsyth Primary School
- Kilsyth Sports Centre
- Kilsyth Tennis Club
- Past members of R.O.C.K.
- Sammy's Music School
- Walmsley Retirement Village Residents & Management

For many years there has been a perception that the Kilsyth area has been overlooked when it comes to development. Surrounding areas have flourished while Kilsyth has seemed to be somewhat at a standstill, a backwater on the border of two large local government regions – Maroondah and Yarra Ranges.

Of course the reality is a little different, with some major initiatives serving to add significant value to our community – things like development of the Pinks Reserve complex, establishment of a new Japara Neighbourhood House facility and the expansion of job-providing industrial precincts.

Nevertheless, with the exception of groups like the Representatives of the Community of Kilsyth (R.O.C.K.) and the Friends of Elizabeth Bridge Reserve, it is fair to say there has been a dearth of community driven initiatives when compared to other districts.

This Community Plan is a serious effort to redress that anomaly. To this end, a great deal of energy and enthusiasm for the task has been generated in a relatively short time.

Commencing in August 2014, there has been a concerted effort to bring members of our community together to produce a shared vision for the future wellbeing of Kilsyth, ideas that people believe will help us to realise that vision, and steps that need to be taken to deliver those aspirations.

From the outset of the consultative process we have been concerned to keep and value our open space and greenery, our recreational facilities, a sense of our history, a village 'look and feel', a feeling of neighbourhood in our streets, of tranquillity and quiet, of safety and security. But we have also sought change. In particular we passionately feel the need to articulate an identity for Kilsyth. We aim to establish a discernible 'heart' for the district, which is linked by a network of arteries - walking trails – that encourage residents and visitors alike to explore and appreciate the amazing offerings that are available in the locality. For our residents young and old, too, we will work to ensure that appropriate support services continue to keep up with local demand as our demographic changes.

We recognise that this document is not a blueprint, nor is it anywhere near the finished product. Rather it is a framework that seeks to give impetus to the unfolding development of thoughts and ideas that will move our area forward over the next few years.

Nor is the Plan the exclusive property of the individuals and organisations involved in the consultations so far. Indeed its ultimate success depends on the engagement of the entire community, and participation in the numerous projects that are coming to life, and those that will emerge under its auspices.

Our immediate priority is to ensure that the energetic groups formed to undertake the initial projects are supported and resourced appropriately. Further on, we will look to the development of a co-ordinating entity to preside over the longer term implementation of these initiatives.



# MAP OF KILSYTH

Kilsyth lies on the border of Yarra Ranges and spills in to the neighbouring Maroondah Council area. Through the consultation process it became apparent that many in Kilsyth do not know where Kilsyth starts and finishes.

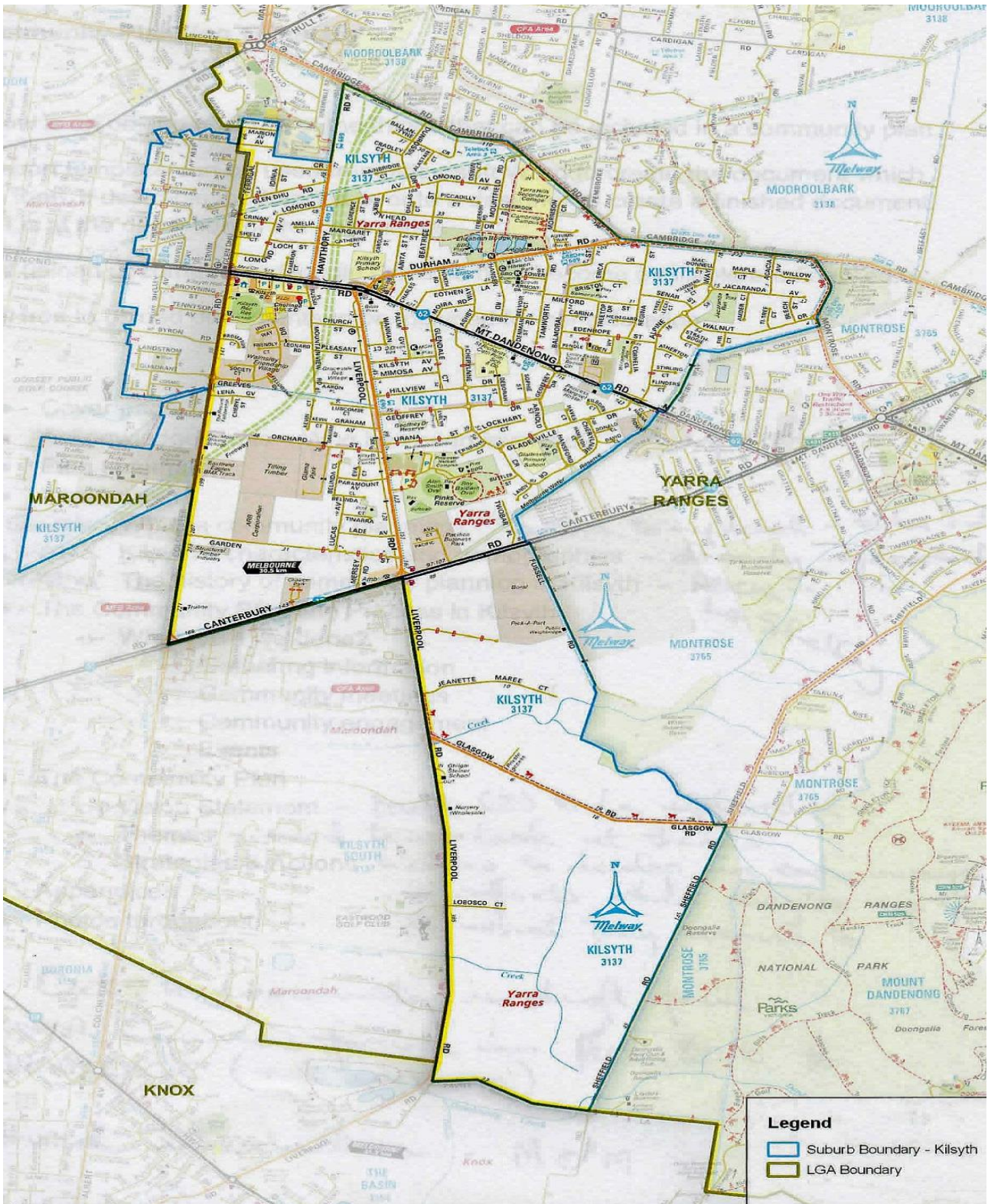

### **Why do we need a Plan?**

Community planning is a process where members of a community come together to identify a shared community vision, priorities and actions that will improve the wellbeing of all members of the community.

The community planning process offers opportunities for communities to increase connections, resilience, leadership and participation.

A Community Plan is owned by the community. All decisions made during the process are made by community members. It is an action-focused document that brings groups and individuals together to create positive change in their community.

Community planning requires varying levels of participation from a diverse cross-section of the community. Some community members will play a significant role in leading the process from start to finish, and others will participate by sharing ideas at a public meeting, providing feedback on a draft plan, or getting involved in a community project.

For the purpose of community planning, a community might be defined by a town's boundaries, a combination of towns with shared goals, or a smaller geographic area with a unique character. It is up to the community to decide what area their plan will cover.

In order for a Community Plan to gain legitimacy and status amongst the community itself, as well as governments and other authorities, a broad cross-section of the community needs to participate in the process of developing the Plan.

### **What Community Planning is not**

Community planning is not a rigid formal process; it evolves over time in response to local needs and interests, to ensure greater community buy-in and participation. Once it is finished, the Community Plan needs to be reviewed and revised regularly.

A Community Plan is not a wish list from the community for local or state government bodies to implement; it is an opportunity for the community to come together to identify resources, skills and attributes that will enable the implementation of the Community Plan.

A Community Plan is not owned by Council, it is owned by the community. It is only through community ownership that real change can occur.



This Plan builds on the work of many who have come before - from the first Kilsyth Progress Association reportedly established March 1977 (however there may have been one established in the 1920s .. if you have any information about this please contact us!), to the more recent achievements of groups like Representatives of the Community of Kilsyth (R.O.C.K.). In looking to future possibilities, it is both instructive and appropriate that we take a quick look at what community action has been able to accomplish in our area in the not so distant past.

### Representatives of the Community of Kilsyth

The Representatives of the Community of Kilsyth (R.O.C.K.) was an energetic township group that operated between 2006 and 2013, which was made up of local people who worked with the community, Council and other government agencies to build a stronger Kilsyth community.

The group initiated a wide range of activities in its lifetime. For example, between 2011 and 2013 these included:

#### Art Projects

- Installing artworks on toilet blocks at Collins Place and Elizabeth Bridge Reserve
- Arranging various youth activities

#### Safety

Arranging or lobbying for:

- footpaths to the bus stop at Durham Road
- lighting in Elizabeth Bridge Reserve
- clean bus stops throughout Kilsyth
- improved street lighting
- Improved control of dogs in public places
- more and safer footpaths and walkways
- clean public toilets
- safety audit of central community locations - covering
- footpaths
- visibility
- parking issues
- removal/trimming of overhanging branches blocking safe pedestrian access

#### Traffic

- Examining issues with entry and exits to shopping centres
- Bus route #690 – improving accessibility for Walmsley residents (i.e.. by diverting to Colchester Rd)
- Installing *Happiest Town* signs

#### Partnerships

- Erecting a community information board
- Pursuing a *history* of Kilsyth
- Linking with other groups (e.g., CWA, FOEBR, local schools) in staging activities such as tree plantings, artwork, design

- Installing recharging points for motor scooters at shopping centres
- Creating an *Ideas Wall* for use by general public (Neighbour Day, 25 March 2012)

### Communication

- Developing a *Welcome Pack* – including high school involvement in seeking ideas for youth activity/needs - partnering with real estate agent to help distribute
- Producing a R.O.C.K. banner for all events
- Developing a R.O.C.K. Youtube and Facebook page
- Conducting a community radio segment to advertise upcoming projects/activities/events
- Producing a *calendar of activities* – clean up and planting days, etc.

### Amenities

- Completing an audit of parks to identify adequacy of BBQs, picnic tables, playground equipment and toilet facilities
- Surveying residents on the future of the toilets at Collins Place

### Clean-ups

- Installing dog poo bags and bins in reserves
- Arranging street gutters to be cleaned more regularly
- Conducting a clean up along Colchester Rd
- Conducting a clean up and planting in Walmsley Park near tennis club

R.O.C.K. managed a number of impressive achievements, some of the mains ones being:

- Painting the wall facing the Eastern Ranges Football Club oval in the Ranges' club colours;
- Removing graffiti and generally cleaning up behind Churinga Village and Kilsyth Shopping Centre, and in Collins Place;
- Conducting a safety audit of Kilsyth;
- Completing a mural on the Eastern Ranges Football clubrooms as part of a youth mentor project in conjunction with the Yarra Ranges Council;
- Commissioning an artist to create two murals on the toilet blocks at the Elizabeth Bridge Reserve depicting the activities and wildlife in the Reserve;
- Assisting in organising and participating in several Neighbour Days at Churinga Shopping Centre;
- Assisting with the delivery of Neighbourhood Watch newsletters (which they continue to do);
- Assisting the Friends of Elizabeth Bridge Reserve and Yarra Hills Secondary College with their annual tree planting;
- Removing graffiti from Liverpool Rd residents' front fences;
- Organising Clean Up Australia Day activities in Kilsyth; and
- Painting over graffiti on the wall of Weg's shop facing Mt Dandenong Rd.

Many of the R.O.C.K.'s initiatives and activities resemble those that have emerged during the consultation phase of the current Kilsyth Community Planning project.

## Adopt a Spot: The Great Wall of Kilsyth

The interest in creating a community plan for Kilsyth grew from a project to clean up the area behind the Churinga Village Shopping Centre. The Great Wall of Kilsyth (formerly the Adopt a Spot, Blank Canvas Project) was a mural project which focused on the back and side wall of the Churinga Village Shopping Centre in Kilsyth. Funded by the Department of Justice the project was a partnership between Council, Walmsley Friendship Village residents, former members of R.O.C.K, Japara Living and Learning Centre and the Victoria Police Crime Prevention Officer.



**The Great Wall of Kilsyth**

After an extensive consultation and workshop process with Walmsley Friendship Village residents and the wider community, artist Daniel van de Weil from SafeHouse Studio designed the artwork. He installed the 110 x 5 metre mural over a three week period with the assistance of local young people and colleagues from his studio.

You can find a video of the launch of the project here:

<https://www.youtube.com/watch?v=ynF3k70OF50&feature=youtu.be>

## Friends of Elizabeth Bridge Reserve

Sadly much of this Reserve's previous life has vanished over time, but it is important to honour the past and acknowledge that this is the land of the Wurundjeri.

The Elizabeth Bridge Reserve attracts hundreds of visitors every month. Some just walk the bitumen paths, others feed the ducks, sit and watch the world go by or gather with family and friends for a picnic, barbecue or to play on the playground equipment. Locals teach their kids how to ride their new bike, some walk their dogs and meet and socialise, talking about the weather and other events.





Thanks to the generosity and foresight of the Bridge family (see history below), everyone now has a wonderful park to enjoy.

The Friends of Elizabeth Bridge Reserve was born out of a desire by local residents like Ted and Dympna Beard to develop greater community engagement in the area. Following the formation of an enthusiastic community group, it was noticed that maintenance of Bridge Reserve was deteriorating. To address this, the group canvassed interest in establishing a Friends organisation. On 19 February 2005 the first meeting was attended by 15 residents and the decision was made to form a Friends group.

Twenty-four inaugural members determined to look after the public amenity of the Reserve and in July of that year the Friends of Elizabeth Bridge Reserve became incorporated, with Jean Bridge as patron.

The Friends celebrated their 10 year anniversary in 2015 with 20-25 members whose aims are still to:

- protect and preserve Elizabeth Bridge Reserve;
- act as a lobby group on behalf of the community of users of Elizabeth Bridge Reserve;
- liaise with the Yarra Ranges Council and Melbourne Water on behalf of the community and users of Elizabeth Bridge Reserve;
- help keep Elizabeth Bridge Reserve clean and tidy by performing tasks such as picking up rubbish;
- note works required and advise appropriate authorities;
- promote use of the Reserve and to disseminate information about the Reserve among the local community; and,
- conduct fundraising or any other activities deemed to be of benefit to the Reserve and the community as appropriate.



**The Chelodina or Eastern Long Neck Turtle that makes its home at Elizabeth Bridge Reserve**

The Friends hold a working bee on the first Sunday of the month and meet in the car park at 2pm. Along the way they have been supported by other community groups such as the Kilsyth Football Club, whose contribution to a tree planting at the Reserve in 2006 was recognised by a Football Victoria Community Club of the Month award.

In 2014 the group organised the inaugural Chelodina Festival. In 2015 the Festival grew in size and patronage. For 2016 the group have secured funding from Yarra Ranges Council to firmly embed the event in Kilsyth's calendar. In 2015 they actively lobbied the State Government and Yarra Ranges Council to have the oval of the former Yarra Hills Secondary College remain for recreational use as part of the Reserve.

## Japara Neighbourhood House

*Japara Neighbourhood House was born from the Montrose Village Network. Formed in 1977, the Network was created to provide a space to bring women together to learn crafts and socialise.*



*The Montrose Village Network secured its own home in 1979 when Lillydale Council purchased the home on Leith Rd. In 1980, Montrose Community House was officially named Japara, after an aboriginal leader who was instrumental in bringing tribes together.*

*In its first newsletter with its new name, Japara House announced that it is “here in Montrose for the purpose of bringing people together in an atmosphere of friendship, to share skills, experience and interests.”*

*Over 35 years later, Japara has grown from a small group of passionate and committed volunteers to a professionally run community organisation. It subsequently moved from Leith Rd in Montrose to Durham Road, Kilsyth, where it moved into a purpose built Living & Learning Centre in 2015.*

*Japara now serves both Kilsyth and Montrose and manages the Living & Learning Centre as well as The Bridge Community Garden Centre. It supports community members of all ages, male and female.*

*Yet, the centre continues to live The Montrose Village Network’s original vision. It still brings people together in a warm and welcoming environment. It provides high quality educational, vocational, recreational and social support services that offer our community opportunities to share skills, experiences and interests.*

*All of the volunteers, Board members and staff who worked with Japara throughout its rich history were fundamental in helping it to become the highly respected Neighbourhood House it is today.*



## The Story of Elizabeth Bridge Reserve

*Elizabeth and Harold Bridge and their three children, Jean, Bill and Elsie, came to live in Kilsyth in 1936. Initially they rented a small house on a few acres of land in Durham Road. At that time there were only four houses from Kilsyth Primary School to the Durham Road/Cambridge Road junction.*

*The land was either bush or orchards. In 1941 they bought a house and farm owned by an old Kilsyth family, the Wylies. The property which was just down from the school consisted of 12.5 acres, including 6-8 old sheds built of bush timber which became very dilapidated and were eventually demolished. They kept cows, horses and poultry for their own use.*

*The house would become the Bridge family home which still stands after some restoration at 33 Durham Road. In 1955 Elizabeth Bridge transferred one acre to her brother Alfred Leonard Riddall who started building a home on the site which was later completed by new owners, the Dummelows. Today that building is the Bridge Community Garden Centre.*

*After Elizabeth Bridge passed away in 1975 it was decided to sell the property. The valuer recommended that the family might give the local Council first option on the land as it would make a lovely park, suggesting the Reserve be named after their late mother, Elizabeth. The Bridge children agreed.*

*In 1979 the Shire of Lillydale purchased the first parcel of land. This ran between the back fences of the homes in Durham Road and Birkenhead Drive. A further parcel was purchased in 1985, comprising 1.067 ha, which included the land now occupied by the Bridge Community Garden Centre car park and part of the land to the west. A third purchase of a westward block was made in the 1990s. To complete the Reserve, the Shire of Lillydale bought an eastern allotment of land from the Orchard family and later, to allow residents greater access, a block fronting Beatrice Street.*

*In 1986 Council developed a concept plan for the Reserve which incorporated plans for an amphitheatre, an ornamental lake and tea lawn, interconnecting paths, a maze, entry plaza with*

*kiosk and toilet facility, a grassed common, barbecue area and lookout, and two playgrounds.*

*The current 3 lake system was later constructed as a "flood retarding basin" and "water clarification area" in response to local concerns about proposals for drainage works by Melbourne Water.*



**An aerial view of Elizabeth Bridge Reserve**



## A Kilsyth History



Then...

Now...

*From the mid-1800s both Kilsyth and Montrose were referred to as South Mooroolbark, lying south of the grand Mooroolbark Cattle Station which had been established by the pioneering John Gardiner in the early 1840s. By 1900 the local residents were lobbying to have their own post office and so a name was needed for the post office. Mr Robert Cameron, who owned the general store on the corner of Liverpool and Ipswich (now Mount Dandenong) Roads was given the task of canvassing the locals for their views. As it happened, Mr Cameron's family had emigrated from the North Lanarkshire village of Kilsyth in Scotland, and the name Kilsyth won the day.*



**Curling!**

*The word 'Kilsyth' itself comes from the Scottish gaelic, but its origin is rather obscure, ranging from its earliest recorded name Kelvesyth, meaning valley watered by the river Kelvin, to a later version, church by the little stream. Either way, it seems to have little to do with our part of the world.*

*Among other things, Kilsyth is famous for the Battle of Kilsyth which saw the Royalists loyal to Charles 1 defeat the Scottish Covenanters in 1645. Coincidentally, the victorious Royalist commander was the 1st Marquess of Montrose. The town also boasts the world's first known (and still surviving) curling club – known as the 'roaring game' because of the sound made by stones when sliding over the ice.*

*Kilsyth in Scotland lies below the Kilsyth Hills to its north. Our Kilsyth lies in the foothills of the Dandenong Ranges to our east. Like the Dandenongs it was a heavily wooded area, and when the pioneers in the district had cleared tracts of land it was found to be productive orchard territory. Gradually the success of the orchardists and grazing land-owners attracted other settlers to the district as land was made available to the Melbourne public.*

*Children in the area would have to walk to Brushy Creek, Mooroolbark South (now Montrose), Croydon or The Basin to get to school. Then, in 1910, a hall (the building on the left in the photo above) near the corner of Mount Dandenong and Liverpool Roads that had been built by local*

storekeeper, Mr John Wilken, was leased by the Education Department to establish Kilsyth Primary School.

In 1912, two acres known as 'Cameron's Paddock' was bought for £120, and Kilsyth Primary School was established on its present site. Two timber classrooms were erected and first occupied in 1915 and were used continually until the fire in 1997. The school children would keep their ponies during school hours in the triangular paddock opposite the school.

Over time however, residential settlement along Mt Dandenong Road grew as weekenders and hillside retreats were built. These residential areas expanded dramatically during the 1960s and 1970s.



OUR POST OFFICE AND STORE, KILSYTH.

### Kilsyth's first post office



### The Kilsyth Environment

Kilsyth has sometimes been referred to as a point on the way to somewhere else. And yet for those who have chosen to live in the district, and those who have come to know of its diversity, its natural beauty and its rich history, Kilsyth is itself a wonderful destination.

### Locality Overview

The suburb of Kilsyth is a large residential suburb 32 km east of Melbourne. It has a substantial commercial and industrial area predominately located on Canterbury Road, stretching from Liverpool Road to Dorset Road. There is also a retail section located on Mount Dandenong Road.

The commercial and industrial areas of Kilsyth offer a range of employment opportunities for residents.

The suburb of Kilsyth is split across Yarra Ranges and Maroondah Councils, with the majority of the suburb within Yarra Ranges.

There are 10,043 residents in Kilsyth, at the time of writing.

### Environmental Characteristics

As a result of residential and industrial development there are few remaining areas of remnant vegetation around Kilsyth. Some smaller areas of vegetation exist along roadsides, in the creek line and in private property which provide a habitat for the remaining fauna in the area.

Trees within the residential and industrial development include a mix of native and exotic species. The Kilsyth South Spider Orchid is listed as a critically endangered flora species. The Colchester Road Retarding Basin and the Bungalook Creek contain a number of important ecological areas, including the Herb Rich Grassy Wetlands which provides habitat for a large range of bird species.

### Transport Options

Kilsyth is on three bus routes that connect the suburb to neighbouring suburbs and Croydon train station. The Croydon to Mount Dandenong service (688) runs regularly Monday to Friday and less frequently on the weekend. This route links Kilsyth with Montrose, Olinda and Croydon. The Croydon to Montrose service (689) runs Monday to Saturday at least hourly between 6am and 5pm. The final bus service is the Croydon to Boronia service (690) which operates at least hourly Monday to Saturday.

Victorian taxis operate within prescribed taxi zones. The urban area of Yarra Ranges sits within the Metropolitan Taxi Boundary. Kilsyth sits within the Metropolitan Taxi Boundary. There are several taxis in operation in the area outside the Metropolitan Taxi Boundary these generally cover the Yarra Valley, Upper Yarra and Hills districts.

## Commercial Features



The main retail area in Kilsyth is on the south side of Mount Dandenong Road from Colchester Road to Russo Place. This retail area comprises three separate shopping centres: the first is a small group of shops fronting Colchester Road, the second is Kilsyth Shopping Centre and the third is Churinga Village Shopping Centre.

There are two smaller retail areas at Collins Place and in Hawthory Road. The major industrial area is found along the east side of Colchester Road and north side of Canterbury Road, crossing over Liverpool Road.



This forms part of the largest and most significant industrial district in the municipality (the adjacent west side of Colchester Road and south side of Canterbury Road falls within the municipality of Maroondah).

## Community Services

Kilsyth boasts several primary schools, maternal and child health centres, kindergartens and other early-years services. Similarly, there are a number of aged care facilities in the district. Japara Neighbourhood House operates a range of programs in its first class facilities including an outreach library service in partnership with Eastern Regional Libraries.

For those community services not available in the vicinity, residents travel predominantly to neighbouring Croydon, Mooroolbark or Lilydale.

The Elizabeth Bridge Reserve includes a lake and a community meeting facility, The Bridge, a venue run by Japara Living and Learning Centre. Other smaller reserves are scattered throughout the region. The Kilsyth Sports Centre and Pinks Reserve in Liverpool Road, and the Centenary Swimming Pool in Hawthory Road, offer active recreational opportunities.

**Please see Appendix 3 for a local services summary.**

# Demographics

## Who Lives Here

Since the early developments of the early 1900s, with only few dwellings and small number of residents, Kilsyth has grown to be a liveable, thriving, leafy suburb in Melbourne with a population of just over 10,000 people (ABS, 2012) at the time of this report.

In 2009 residents of the suburb of Kilsyth were identified as the ‘happiest people’ in Australia, following a national online survey ‘The Test’ of 50,000 respondents.

### Quick Snapshot of Kilsyth (Source: ABS, 2013)

<b>Total Land Area</b>	824.2 hectares
<b>Total Population</b>	10,043 persons
<b>Population Density</b>	
<b>Average Family Size</b>	2.9
<b>Median Age of Persons</b>	39 years
<b>Main Ancestry</b>	Australian, English, Irish and Scottish
<b>Unemployment</b>	
<b>Key Areas of Employment</b>	Manufacturing, Retail, Construction, Health Care and Social Assistance

### Happiest Town in Australia in 2009

## Population

Based on the 2011 Census data, Kilsyth’s population is 10,043 persons with a projected population growth of 0.81% year on year.

The median age in Kilsyth is 39.7 years and the highest proportion of residents are in the 25–40 and 50-65 age categories (Fig 1.1).

Fig 1.1

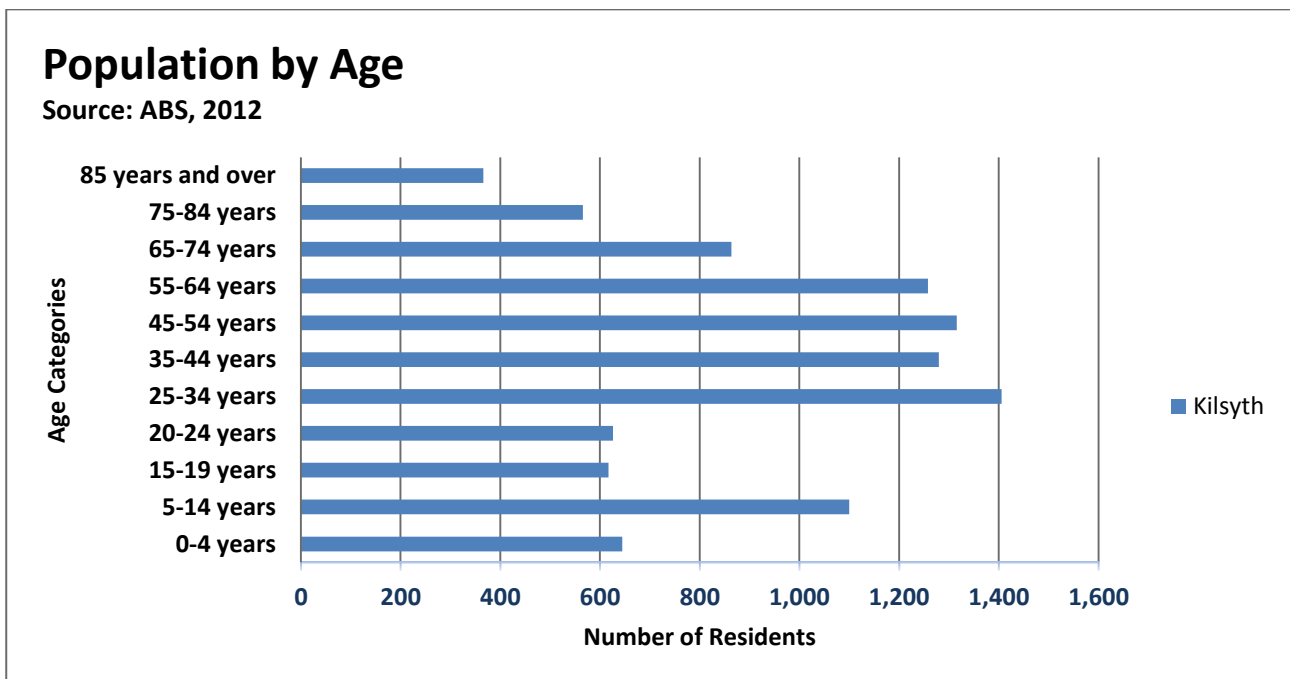

## Marital Status / Family Composition

Marriage is important for the people of Kilsyth with the highest proportion of the population being married (47%)\*, however there is still a large proportion who have never married. Compared with Victoria’s marital statistics, Kilsyth has a slightly higher percentage of the population that are divorced, widowed or separated (Fig 2.0). In total there are 2327 families (ABS, 2012) in Kilsyth of which 31% have children aged less than 15 years in coupled family, 38% coupled families with no children and 19% one parent families.

Fig 2.0

### Kilsyth Population by Marital Status\*

Source: ABS Statistics, 2012

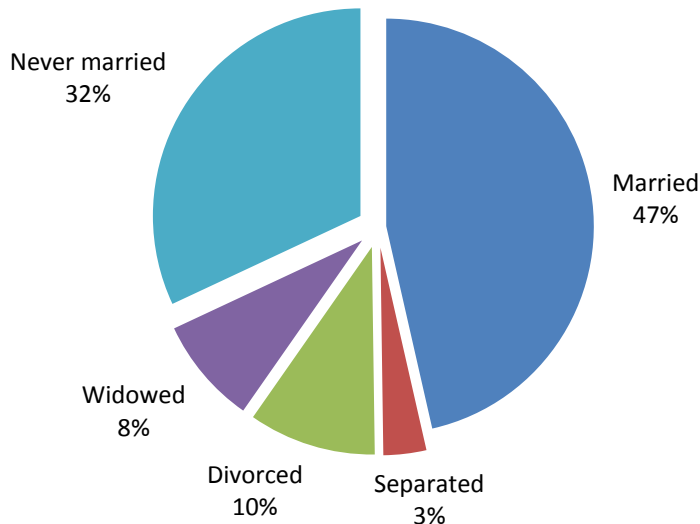

\* 15 years and over

Fig 2.1

### Families by Type

Source: ABS Statistics, 2012

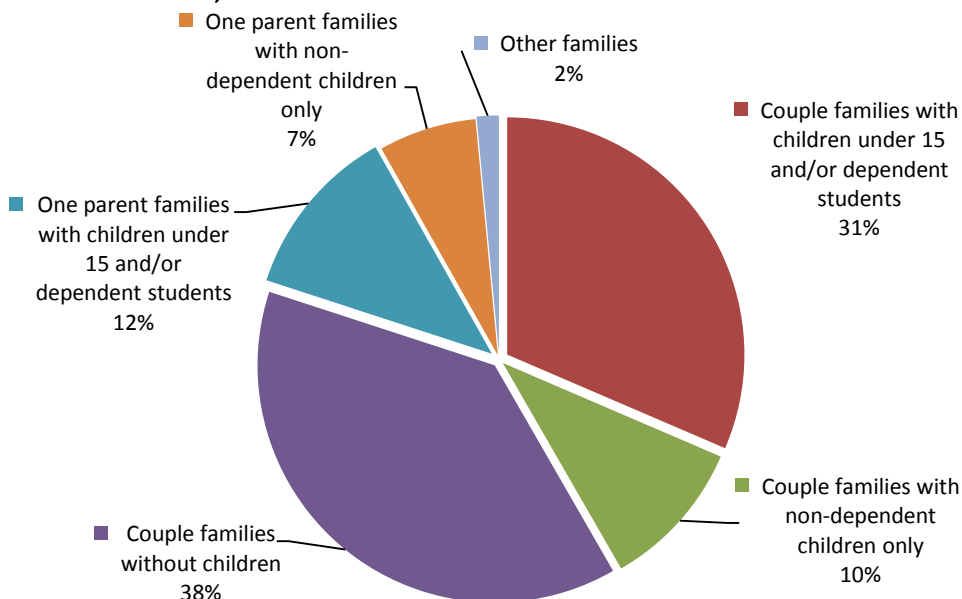

## Cultural Diversity

Kilsyth is a culturally diverse area represented by over 35 countries of origins by birth.

Some of the more populous groups – besides Australian - include United Kingdom, Netherlands, New Zealand, Germany, India and Philippines (Table 2.1).

Looking at the ancestry of the residents – based on one or two parents born overseas – the highest ancestry groups – besides Australian - are English, Irish and Scottish (Fig 2.1).

**Table 3.0**

COUNTRY OF BIRTH OF PERSON(a) BY SEX  
Count of persons

	<i>Males</i>	<i>Females</i>	<i>Persons</i>
Australia	3,738	4,079	7,817
Bosnia and Herzegovina	3	4	7
Cambodia	0	3	3
Canada	3	5	8
China (excl. SARs and Taiwan)(b)	12	8	20
Croatia	3	0	3
Egypt	0	7	7
Fiji	5	0	5
Former Yugoslav Republic of Macedonia (FYROM)	0	0	0
Germany	59	61	120
Greece	4	7	11
Hong Kong (SAR of China)(b)	0	0	0
India	29	34	63
Indonesia	3	7	10
Iraq	0	0	0
Ireland	16	12	28
Italy	26	17	43
Japan	0	9	9
Korea, Republic of (South)	0	5	5
Lebanon	3	3	6
Malaysia	12	7	19
Malta	7	6	13
Netherlands	82	99	181
New Zealand	52	73	125
Philippines	16	42	58
Poland	0	8	8
Singapore	3	3	6
South Africa	15	25	40
South Eastern Europe, nfd(c)	4	4	8
Sri Lanka	8	9	17
Thailand	3	10	13
Turkey	0	5	5
United Kingdom, Channel Islands and Isle of Man(d)	379	416	795
United States of America	10	10	20
Vietnam	3	3	6
Born elsewhere(e)	101	72	173
Country of birth not stated	200	188	388
<b>Total</b>	<b>4,799</b>	<b>5,241</b>	<b>10,040</b>



Fig 3.0

### Kilsyth Population by Ancestry\*

Source: ABS Statistics, 2012

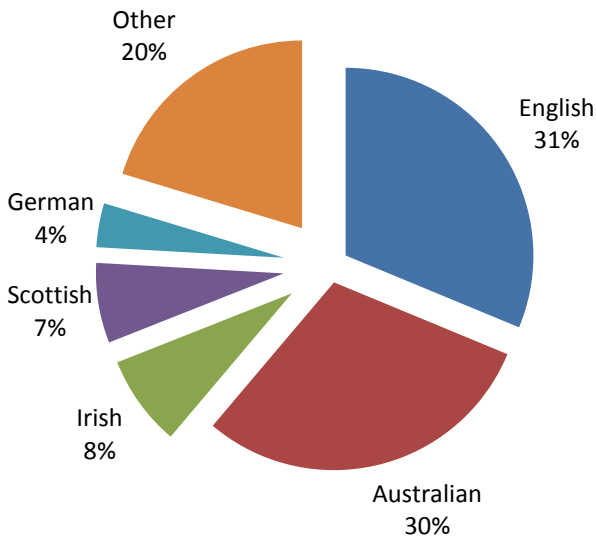

\* total responses were 13,380

### Employment

The unemployment rate in Kilsyth, based on latest Census data (ABS Statistics, 2012) is 4.05% of the total labour force of 5116 people (males and females). Those who are employed in the 20 – 54 age category, more than twice as many are employed in full time work compared with part time work (Fig 4.0)

Fig 4.0

### Labour Force Status by Age

Source: ABS Statistics, 2012

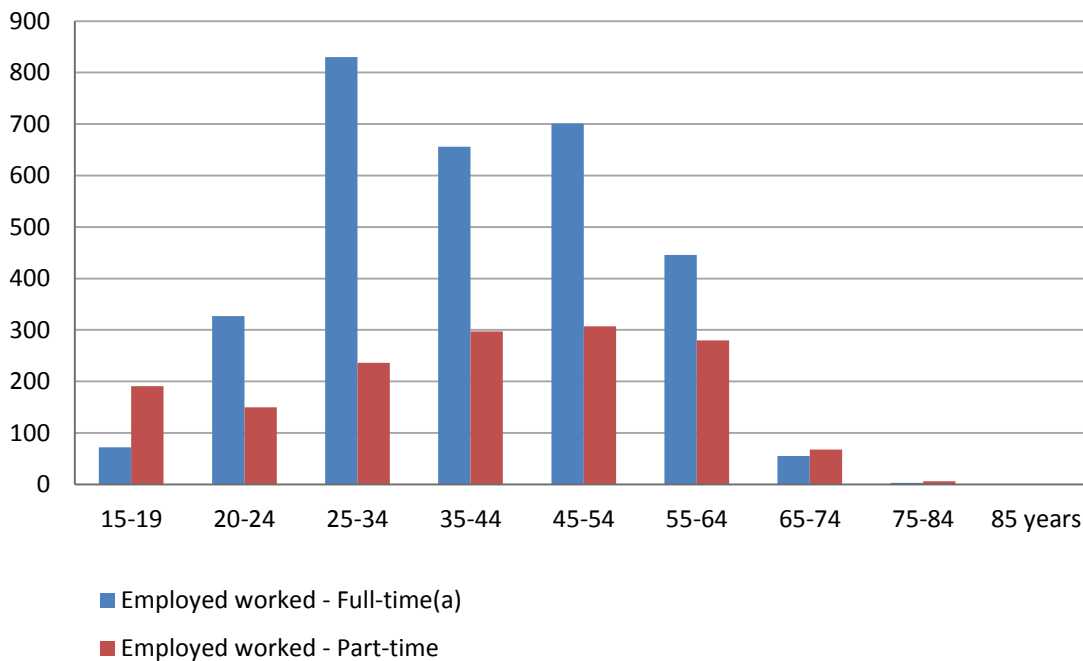

The key occupation categories for Kilsyth workers are presented in the figure below.

Fig 4.1

### Employment by Occupation

Source: ABS Statistics, 2012

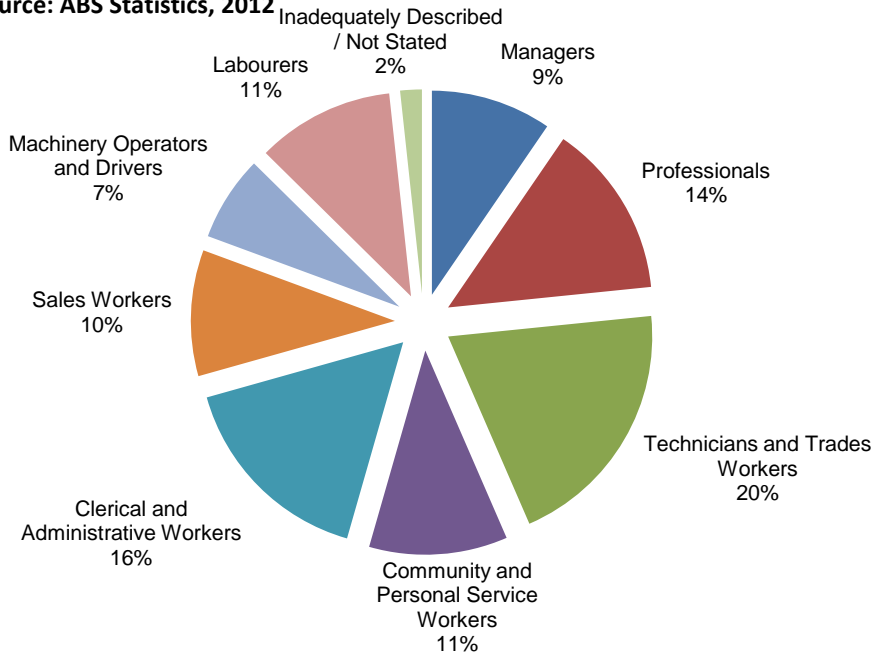

The key industries that provide employment for Kilsyth workers are presented in the figure below with Manufacturing, Construction, Retail Trade and Health Care and Social Assistance industries being the largest employers (Fig 4.2).

Fig 4.2

### Industry of Employment

Source: ABS Statistics, 2012

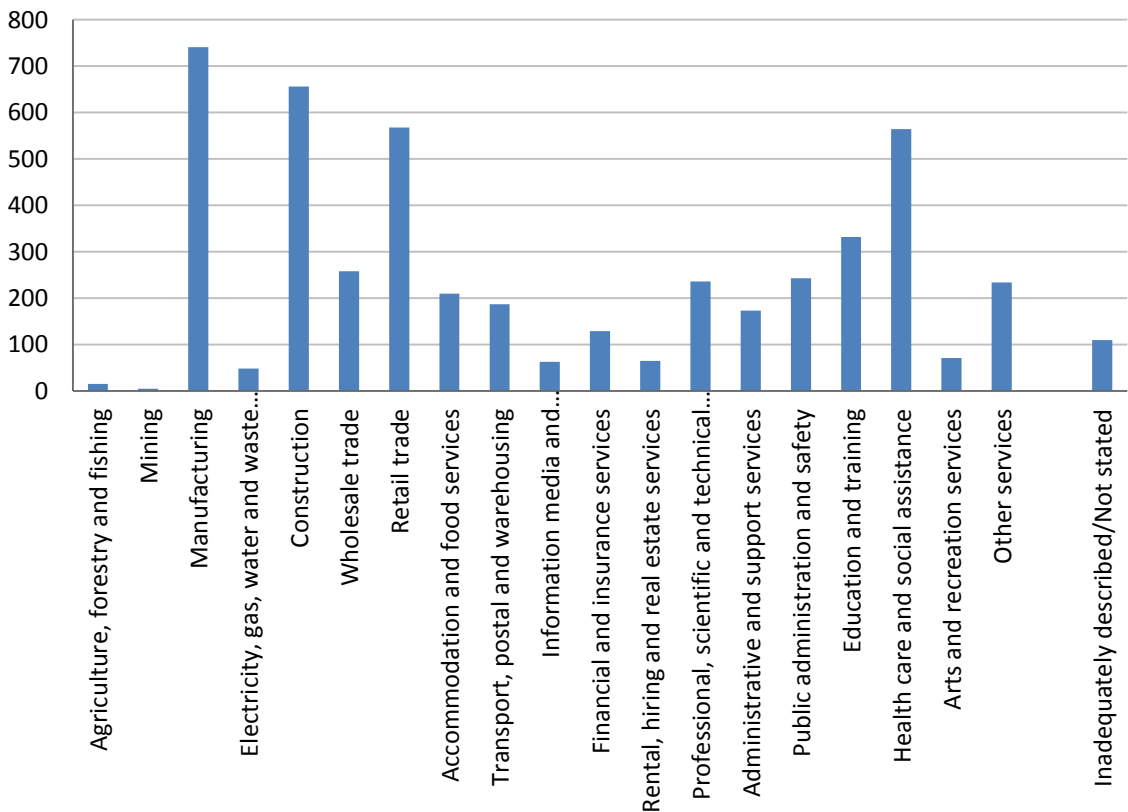

## Education

Though there are no High Schools, TAFE Institutes or Universities in the suburb of Kilsyth, in 2011 there were 2683 students enrolled into some level of formal education; predominantly into Primary and Secondary Government schools.

One in every 5 enrolled students were studying some form of further education in TAFEs and Universities obtaining technical competency.

### Kilsyth Education Statistics

Source: ABS Statistics, 2011

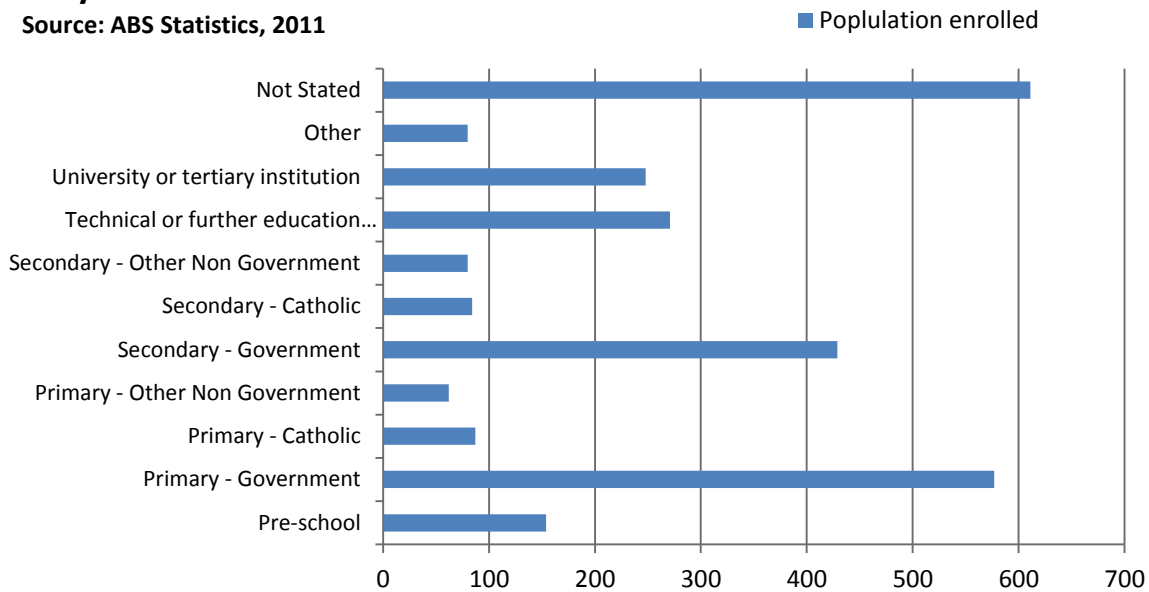

## Housing

This suburb is characterised by the traditional quarter-acre blocks with most dwellings being separate houses (78%), however the demand for smaller housing types for the single, small families and mature aged residents has seen an increase of other dwellings types including units (17%) and townhouses (5%).

With Melbourne's urban growth in the outer east, these statistics will likely change and the further growth of townhouse and unit style housing options and land sub-divisions for residents will certainly re-paint the housing scene in Kilsyth.

### Dwelling Structure

Source: ABS Statistics, 2012

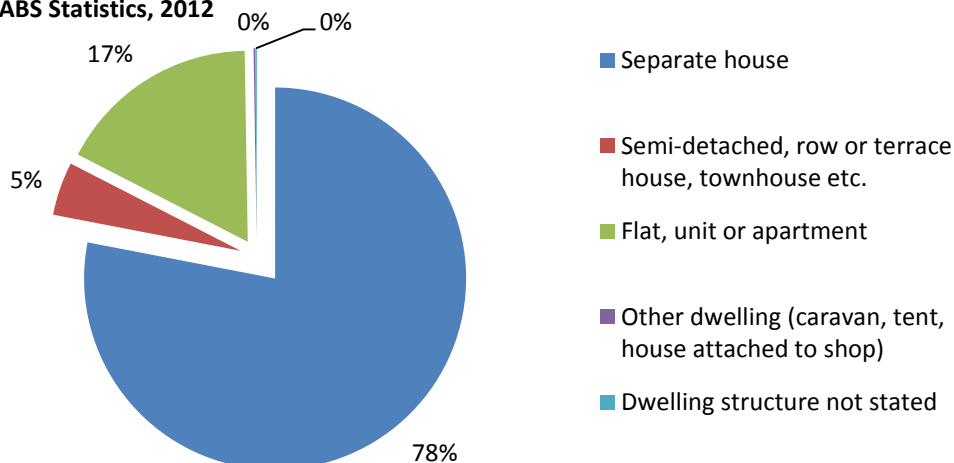

The success of the Great Wall of Kilsyth in bringing community and local leaders together to foster connectedness in Kilsyth initiated the Kilsyth Community Planning Process.

### **August 2014**      **What Is Community Planning?**

#### *Kilsyth Memorial Hall*

A workshop with leaders, schools and agencies was facilitated by Council officers at the Kilsyth Memorial Hall to present the idea of developing a community plan. Key themes and a list of community assets were identified. Links were

made between participants. It was agreed that Kilsyth Community Planning should proceed.



### **September 2014**      **Kilsyth Primary School Community Fair Consultation**

Council officers and community members held an interactive consultation stall at this local event. Questions canvassed were:

- What skills and knowledge could you bring to community planning?
- What isn't here? What would you like to create?
- What would you like the community to change about Kilsyth?
- What do you like best about Kilsyth?
- Other feedback



### **October 2014**      **Statistics, Demographics, Inspiration and Community Planning**

#### *Kilsyth Memorial Hall*

A workshop open to all in the community. Recapping the process of community planning and covering the responses gleaned from the Kilsyth Primary School Fair, the session presented statistics and demographics of Kilsyth to help the group identify possible key foci for the Kilsyth Community Plan. Council officers presented capital works projects currently planned for Kilsyth. Several inspirational community development projects were presented for consideration, including a video made of the launch of the Great Wall of Kilsyth.



**November 2014**      **Great Projects Workshop**  
*Kilsyth Primary School*

The group was invited to rank their favourite project ideas from those generated at the previous workshop and consultation. Six projects were selected and groups began planning: What? How? When? Who? Why?



A timeline for the Community Plan was proposed and accepted.

**December 2014**      **Community Consultation – The Chelodina Festival**  
*Elizabeth Bridge Reserve*

Project ideas and planning generated at the November meeting were presented to the community for feedback. New ideas were also sought. Circus Ruccis and Sammy's Music School performed and an idea was formed to present a Youth Event in April 2015 to engage young people in the Kilsyth Community Planning process.

**February 2015**      **Project Planning**

*Japara Living & Learning Centre*

Results from the December consultation were presented and discussed. The group began developing detailed project plans for each of the identified projects.

***Concurrently to community workshops, Council officers began meeting with subgroups to help clarify the vision and planning for their projects.***

**March 2015**      **Including the Community**

*Japara Living & Learning Centre*

This workshop covered barriers to participation and how to include the hard to reach in the community planning process.



**March 2015**

### **Community Consultation – Kilsyth Primary Twilight Market**

Community members and Council officers held an interactive consultation stall at this local event promoting the project ideas under development and seeking input and participation from Kilsyth community.

**April 2015**

### **Community Consultation - BridgeFest**

*Kilsyth Memorial Hall*

This event brought local arts organisations; Circus Ruccis; Sammy's Music School; and, Kaycee's Academy of Dance to share the outstanding skills of Kilsyth's young people. Council's Youth Services team were on board to talk with young people as well as representatives from

Knox Headspace. The weather was atrocious and the event had to be moved indoors. The highlight of the day was the creative collaboration between Sammy's Music School musicians and the aerialists from Circus Ruccis.



**Circus Ruccis and their free standing aerial rig at Bridgefest**

**May 2015**

### **Writing a Community Plan, Visioning & the Opportunities Plan**

*Japara Living & Learning Centre*

This workshop covered what goes in a community plan and the process for gathering the information. The group then developed three alternative vision statements for Kilsyth. The 'Opportunities Plan', developed by Council in response to the planning process, (from capital expenditure allocated externally to the planning process) was presented by Council's Precinct Designer and feedback provided.

Subcommittees were requested to provide draft project plans to the Kilsyth Community Plan writers for inclusion in the Plan.

**June 2015**

### **Writing the Community Plan**

*Japara Living & Learning Centre*

This workshop looked at all the ideas generated throughout the community planning process and categorised them under the project ideas. The group prioritised ideas and began to formulate strategies for their inclusion in the Community Plan.

**July 2015**

**Project Updates**

This workshop focused on updating the group on the developments by subcommittees of the key projects and identified synergies and opportunities between the projects, creating a strong vision for the siting of all projects within the one Plan.

- The Kilsyth Common & Town Centre
- The Chelodina Festival
- Unleash the Dog Park
- Kilsyth Walk

**August 2015**

**Kilsyth Common & Town Centre**

*Grant Submission to the Department of Justice*

The community process took a break in August while the Kilsyth Common & Town Centre subcommittee supported Council officers to prepare a significant grant application for the development of the open space in and around the Kilsyth shopping precinct. If successful these funds will support infrastructure funding already allocated to Kilsyth.

**September 2015**

**Draft Kilsyth Community Plan Writing**

*Mike O'Meara & Shelley Large*

The community process took a break while Mike and Shelley compiled information and scribed the first draft Kilsyth Community Plan with Council officer assistance.

**October 2015**

**The Engagement Plan**

*Japara Living & Learning Centre*

This workshop revisited ideas developed at the March meeting on how to involve the whole community in the planning process and encourage the community to read and feedback on the Community Plan. A schedule was designed to hold four public engagement activities throughout November as well as online and social media.

**November 2015**

**The Community Plan Engagement**

**Please see Appendix 6 & 7 for survey and consultation results summaries.**

Online – The Community Plan was/is hosted online and the link shared through networks. A survey was developed which was accessible on line for community to offer feedback and ideas.

Facebook – The Plan and engagement process was promoted through social media.

**12<sup>th</sup>** Town Centre subcommittee members informed traders about the upcoming engagements, Kilsyth Community Planning process and invited their ideas and feedback.

**15<sup>th</sup>** The Chelodina Festival – Community Planning Group members hosted a stall at the Festival to promote the Plan and invite engagement with and feedback about it.

**21<sup>st</sup>** Churinga and Kilsyth Shopping Centre - Community Planning Group members hosted a stall to promote the Plan and invite engagement with and feedback about it.

**28<sup>th</sup>** Kilsyth Sports Centre - Community Planning Group members hosted a stall to promote the Plan and invite engagement with and feedback about it.

<b>February 2016</b>	Integrate consultation/survey results in to the Kilsyth Community Plan Final Kilsyth Community Plan Design
<b>March 2016</b>	Present the Kilsyth Community Plan to Council for acknowledgement
<b>April 2016</b>	Launch the Kilsyth Community Plan Host Community Plan online and disseminate through social media Print limited copies and disseminate to key venues
<b>May 2016</b>	Facilitated workshop for Kilsyth businesses

## CONSULTATIONS – WHAT WE LEARNED

### Themes

At the initial Community Consultation forum on 26 August 2014, community representatives agreed on a number of themes that they regarded as important and relevant to the development of Kilsyth. These were affirmed by later consultation events with the wider community.

The themes identified were:

- Communications
- Vulnerable Groups
- Older People
- Community Identity
- Sport and Recreation
- Young People

The ideas that brought these themes to the forefront were:



## Communications

- New migrants in the area – new demand for information
- Promoting local interest groups – e.g., sports clubs and arts groups
- Local newspaper operators – need to be on board
- Local newspaper delivery needs to be consistent and comprehensive in the area
- Communication at a premium since no Kilsyth Chamber of Commerce
- Village Noticeboard
- Ready access to information – easy for all to find
- Promotion of events
- Awareness of community leaders
- Facilitate process to bring groups together
- Schools interested in a medium to share news / achievements / interests of students and for them to be involved in their community
- Vehicle for promoting knowledge of local history
- Kilsyth website – Facebook – to access events, services and information updates

## Vulnerable Groups

- Meals – Social Isolation – Disadvantage – Homelessness – Mental Health – Family Violence
- Need to identify a focus to facilitate connection – e.g., use meals as an opportunity to create social engagement, link people to services and address other needs
- Promoting awareness of existing local services for these groups
- Develop strategies to help reach and engage these groups.
- Creation of “second step” services (i.e.beyond meals) that can empower, skill up, etc.

## Older People

- Need to recognise as a great resource in the community
- Liaise with Walmsely Village Residents Committee
- Local war veterans and war widows
- Aged aren't always in villages - engage with people in their own homes
- Activities that encourage active past-times, social interaction, community connection
- Activity experiences – stimulating minds and keeping bodies fit
- Getting out of the “homes” mentality – sharing between the “village” or care facility and the community.
- Sharing experiences with other demographics - e.g., mentoring in schools or businesses
- Optimising use of local recreation resources
- Random police patrols behind Churinga shops – promotion of security, safety
- Establish meeting places – e.g., a “Men’s Shed”.

## Community Identity

- Identifying local treasures – self-promotion – idea of a ‘heart’ for Kilsyth – enhancing a sense of place and belonging – need for a common gathering place

- Find ways for students from local schools to connect with their community and represent their school and their learning
- Acknowledge that there are actually a number of “centres” or “hearts” of Kilsyth, not one – for example:
  - Pinks Reserve precinct
  - Collins Place
  - Bridge Reserve/Japara
  - Churinga Shopping Centre/Memorial Hall
- Acknowledge and promote Kilsyth’s “treasures” - many not aware of all Kilsyth has to offer
- Develop a map of interesting places
- Supplement the local newspaper style of communication with Information boards containing information about local recreation facilities
- Social media – Twitter, Facebook and Instagram of places of interest
- Publicise list of local resources
- Use planned features and activities to encourage sense of gathering - for example
  - Wild Bird Park
  - Community gardens
  - Art classes
  - Miniature Railway – Killoran Park

## Sport and Recreation

- Build awareness of accessibility of sport and recreation facilities available to ALL age groups and abilities, including vulnerable groups
- Identify and capitalise on synergies among existing groups – e.g., Pinks Reserve co-tenants (basketball, badminton, table tennis, football, cricket, softball, netball)
- Exploit uniqueness of Circus Ruccis
- Inclusion of Centenary Pool in recreation discussion
- Need for off lead area for dogs
- Potential for developing horse trail-rides – foothills, Sheffield Rd

## Young People

- Promote reach of Sports Clubs to bring local young people together
- Survey how many young people engage in local community activities
- Use Council’s Youth Services database to inform discussion
- Extend Elizabeth Bridge Reserve to include former Pembroke Secondary College oval and create youth space
- Local primary schools properties – enlist Council support to equip / promote / facilitate -
  - sharing facilities and resources
  - advancing community use
- Consult students at local schools and clubs to gather information on their expectations
- Develop shopping centre precincts to create community spaces
- Create a Youth hub (similar to Croydon Skate Park / playground)

## STRATEGIES AND ACTIONS

The themes and ideas identified through the consultation process have translated into four key (4) project areas:

- Kilsyth Common and Town Centre Project
- Kilsyth Off Leash Dog Park
- Kilsyth Walks - Heritage Walking Trail
- Chelodina Festival

**Please see Appendix 2 for an overview of how the community's ideas fit in to emerging projects and reflect the Kilsyth Community Plan themes.**

### KILSYTH COMMON AND TOWN CENTRE PROJECT

Kilsyth's main retail shopping precinct on Mount Dandenong Road has received the most significant feedback throughout the consultation process. In response, a group of residents with a passionate interest in improving the amenity of this area has formed to pursue its development as a community, commercial and recreation 'heart' of the district in keeping with the broader vision of the Community Plan.

Our aim is to make the Kilsyth and Churinga Shopping Centre a vibrant meeting place and the shopping destination of choice for the local community. This will be achieved by working together with both the wider community, property owners and traders.

**Please see Appendix 5 for initial detailed project ideas developed by the subcommittee.**



**Aerial shot of Kilsyth & Churinga Shopping Centres, Eastern Rangers Football Club, Kilsyth Memorial Hall, Kilsyth Tennis Club and surrounding open space**

## OFF LEASH DOG PARK

The vision for the Kilsyth Off Leash Dog Park is to have a dedicated park and clubhouse which will promote and facilitate responsible dog ownership and the benefit of animal companionship. This will be achieved by focusing on the legitimate needs of pets and their owners, while respecting the rights of other members of the community and protecting the environment.

The Kilsyth Off Leash Dog Park (KOLDP) will be good for the socialisation of our dogs. Further, the mental health of owners cannot be underestimated. Caring for a dog gives purpose to the life of an elderly, lonely or disabled person and walking means a healthier body. The social interaction gained by meeting other like minded people is enormous.

## THE CHELODINA FESTIVAL

Friends of Elizabeth Bridge Reserve is an active environmental group protecting and preserving Elizabeth Bridge Reserve (Kilsyth). As part of this group we are keen to attract people to the reserve and to encourage community participation.

The 'Chelodina Festival' was delivered in 2014 to encourage the local community to live a healthy, environmental and sustainable way through showcasing the Elizabeth Bridge Reserve. The significance of the name 'Chelodina' is the scientific name for the Eastern Long Neck Turtle which is found in the water bodies of the reserve. It is hoped that the image of the turtle will become the mascot of Kilsyth and attract further support for this festival; currently community members are starting to recognise the turtle in this way.

The aims of the Chelodina Festival are to:

- showcase and promote understanding of the area's natural resource (the Reserve) through creativity;
- engage community participation and build a better relationship with the Kilsyth community and surrounding areas;
- educate the community on topics of Environment, Sustainability and Health through local business, community groups and schools contributions;
- attract new members to the group;
- encourage people to live a healthy and active lifestyle; and,
- promote the use of and disseminate information about the reserve.

**CHELODINA FESTIVAL**  
Home of the Eastern long necked turtle

8.30am Curves

9.30am Dog training

10.30am Melbourne Uni Turtle Discovery

11am Featuring: Vasili Kanidiadis Garden Guru

12noon African Drumming Workshop

guest speaker

**SUNDAY 15 NOV 2015**  
FREE EVENT  
Something for everyone!

Ruccis Circus / MFB / Softball Sammy's Music School and More.  
At Elizabeth Bridge Reserve  
49 Durham Rd, Kilsyth.

Friends of Elizabeth Bridge Reserve

Yarra Ranges Council



# KILSYTH WALK

The Kilsyth Walk builds on the broad vision of the Kilsyth Community Plan to create a 'heart' for Kilsyth. The creation of an established pathway will provide a key contribution to the development of a unique cultural and social identity of the town, which residents and visitors alike can be a part of. The Kilsyth Walk will address three main aims:

- to link the identified centres/hearts/hubs of Kilsyth, thereby creating a visual boundary and sense of geographical 'place' for the residents;
- to build a unique social and cultural narrative for the area (via the identification and promotion of key historical and geographical markers); and
- to create a practical resource for visitors and residents which identifies local amenities, services and points of reference.

It is expected that local residents and agencies will be the key resources in the development of the Walk which will be the critical link connecting the individual initiatives being planned as part of the Kilsyth Community Plan and establish agencies.

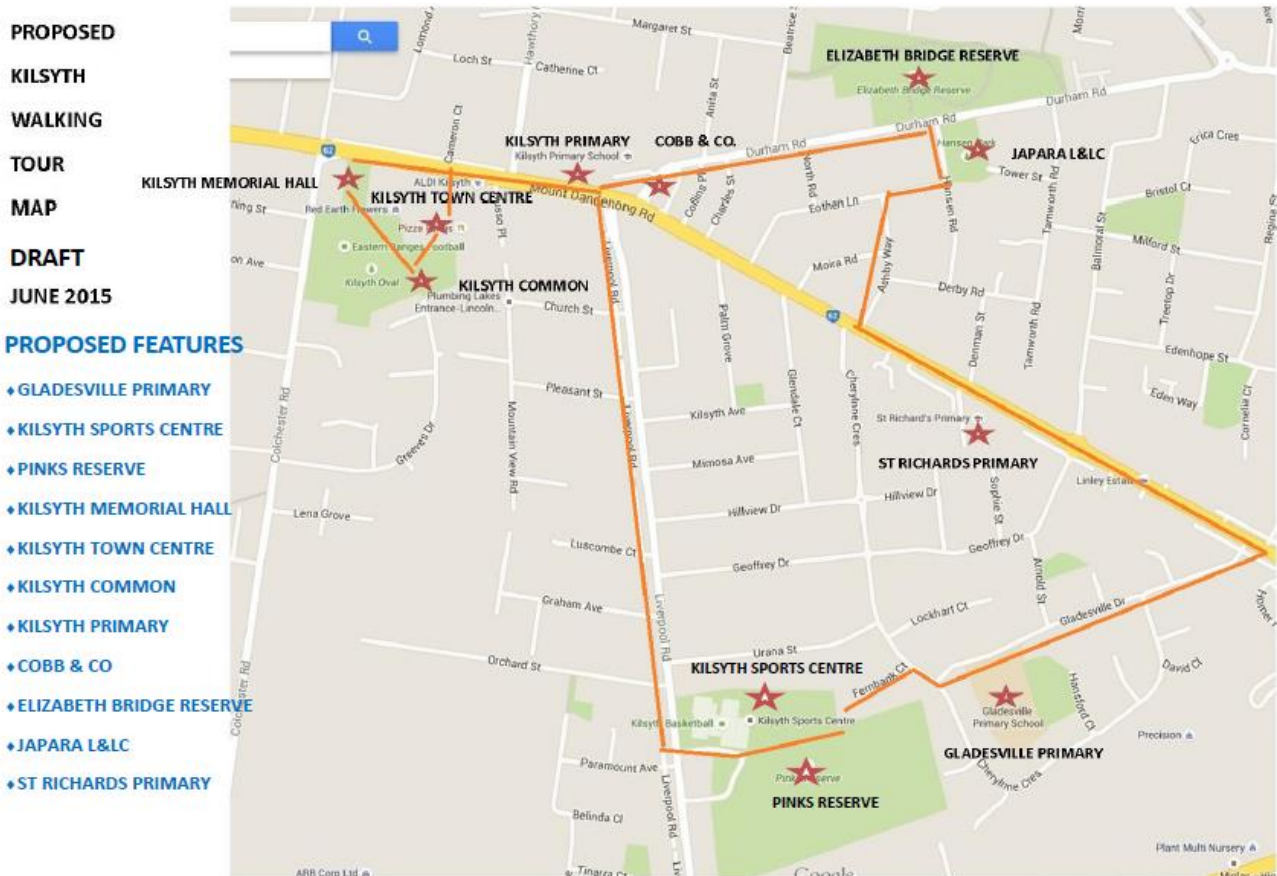

## KILSYTH COMMUNITY ACTION PLAN

### Kilsyth Common & Town Centre Project

ACTION	NEXT STEPS	WHEN	DONE	CONTACT
Establish subcommittee	Subcommittee established to focus on Kilsyth's shopping precinct and its recreational and infrastructure environs	June 2015	Ongoing	Mike O'Meara Neil Cameron Laszlo Csernatony
Develop urban design concepts	<ul style="list-style-type: none"> <li>• Urban design concepts developed which address improved access and amenity in the space at the rear of the shopping centre, for the benefit of users from the adjacent Walmsley Retirement Village and other residents.</li> <li>• Concepts plan submitted to YRC has received funding alongside three other areas within Kilsyth for detail design and delivery over 2016/17.</li> </ul>	Aug 2015  2016/17	Done  2018	Mike O'Meara Peter James Neil Cameron Laszlo Csernatony  YRC Built & Active Spaces
Engage Kilsyth/Churinga traders	<p>Conduct personal visits to centre management, business owners/staff and property owners, informing of Community Planning process and seeking involvement and feedback of ideas:</p> <ul style="list-style-type: none"> <li>• advise program of visits by email and mail;</li> <li>• provide 'Community Plan in a Nutshell' doc;</li> <li>• provide information about <i>Mainstreet Australia</i>;</li> <li>• advise about Kilsyth Community Plan engagement activities throughout November</li> </ul>	Nov 2015	Dec 2015	Mike O'Meara Neil Cameron Elizabeth Hobbs
Engage Kilsyth/Churinga shoppers	Conduct promotional and engagement event in the shopping centre, informing of Community Planning process and seeking involvement and feedback of ideas:	Nov 2015	Dec 2015	Shelley Large Laszlo Csernatony Len Cox Malcolm Large

ACTION	NEXT STEPS	WHEN	DONE	CONTACT
	<ul style="list-style-type: none"> <li>• hold information stall;</li> <li>• provide promotional materials;</li> <li>• provide access to online survey completion;</li> <li>• activities for children</li> </ul>			Neil Cameron Mike O'Meara Mieke Alexander
Develop strategic planning	Develop interim and long term strategies in response to engagement and feedback activities: <ul style="list-style-type: none"> <li>• expand subcommittee to include interested traders and community members;</li> <li>• distil and prioritise ideas obtained during engagement process;</li> <li>• cross-reference with developments in other Community Plan projects;</li> <li>• develop implementation Action Plan and timeline</li> </ul>	Dec 2015 – Feb 2016	Mar 2016	Mike O'Meara Neil Cameron Laszlo Csernatony
Arrange <i>Mainstreet Australia</i> workshop	In partnership with YRC coordinate workshop by leading economic revitalisation organisation for local traders and small business	Apr 2016		Santha Press Mike O'Meara Neil Cameron Laszlo Csernatony
Review strategic planning	Revise strategies and update Action Plan in response to findings from <i>Mainstreet Australia</i> workshop	May 2016		Committee

## Kilsyth Walk

ACTION	NEXT STEPS	WHEN	DONE	CONTACT
Stage 1 of Kilsyth Walk: Build on sub committee / working group	<ul style="list-style-type: none"> <li>Identify key community members to approach</li> <li>Gather best practice examples of local walks, consulting with other local groups</li> </ul>	Feb 16	Ongoing	Mike O' Meara
Establish partnerships	<ul style="list-style-type: none"> <li>Contact key agencies along the path</li> <li>Encourage agencies to join subcommittee</li> </ul>	Feb 16	Apr 16	Mike O' Meara Nicole Wood
Communications	<ul style="list-style-type: none"> <li>Face to face meetings schedule (as required) confirmed</li> <li>Email contact in between meetings for circulation of documents and feedback</li> </ul>	Feb 16	Ongoing	
Formulate a project timeline and action plan	<ul style="list-style-type: none"> <li>Establish shared objectives for the project</li> <li>Develop a project timeline and action plan which incorporates: gathering historic information; gathering information from key agencies; develop resource map; and the Kilsyth Walks event.</li> <li>Invite key agencies to develop discreet projects that feed in to the walk</li> <li>Accommodate way finding signage provided by Council</li> </ul>	Apr 2016	Jun 2016	Mike O' Meara Nicole Wood  Built & Active Spaces YRC



Research funding available	<ul style="list-style-type: none"> <li>• Council &amp; Heritage grants</li> </ul>	Mar 2016		Kerryn Morey
Promote Kilsyth Walks event	<ul style="list-style-type: none"> <li>• Facebook</li> <li>• Local paper</li> <li>• Email out</li> <li>• Schools newsletters</li> <li>• Poster</li> </ul>	Mar 2016		Committee
Kilsyth Walks event	<ul style="list-style-type: none"> <li>• Walk with school children from participating schools and community</li> </ul>	Apr 2016	Apr 2016	Mike O' Meara
Submit funding applications	<ul style="list-style-type: none"> <li>• YRC</li> <li>• Others?</li> </ul>	Jul 2016		
Agency projects	<ul style="list-style-type: none"> <li>• Agencies run their projects which are linked by the trail</li> </ul>	2017		
Way finding signage	<ul style="list-style-type: none"> <li>• Installed by Council</li> </ul>	Apr 2017		YRC
First draft of Walking map developed	<ul style="list-style-type: none"> <li>• Research and projects gathered</li> <li>• Funding sought to produce map</li> <li>• Draft produced for Walking event</li> </ul>	2018		Mike O' Meara
Kilsyth Walks event	<ul style="list-style-type: none"> <li>• Walk with community</li> </ul>	2017		Mike O' Meara Nicole Wood
Walking map	<ul style="list-style-type: none"> <li>• Finalised, produced and distributed</li> </ul>	Apr 2017		Mike O' Meara
Stage 2 development	<ul style="list-style-type: none"> <li>• Stage 2 development planning beginnings based on funding outcomes</li> </ul>	2018		Mike O' Meara Nicole Wood

## The Chelodina Festival

ACTION	NEXT STEPS	WHEN	DONE	CONTACT
Community Festival	<ul style="list-style-type: none"> <li>Organise a Festival in the Elizabeth Bridge Reserve to showcase the Reserve and all it has to offer</li> <li>Engage YRC help and hold discussions as to how and when to organise a festival</li> </ul>	2014	Yes	FOEBR Committee
Promote & engage community	<ul style="list-style-type: none"> <li>Identify what is required to attract local people to attend and share responsibility for inviting</li> <li>Contact groups which have been identified to see if they would like to participate</li> </ul>	Jun 2014	Yes	FOEBR Committee and members
Plan Festival	<ul style="list-style-type: none"> <li>Chose a date to hold the Festival and name it</li> <li>Program event</li> </ul>	Jun 2014		FOEBR Committee
Advertising	Posters, mail out, electronic sign board	2014	Yes	YRC and FOEBR members
Chelodina Festival	Greencross Vet Kilsyth, Melbourne Water, Candlebark Nursery, Busimanns Dog Training, Ruccis Circus, Sammy's Music School, Kofi Kunkpe Music , Montrose Rotary, MFB Croydon	5 Dec 2014	Yes	FOEBR President Graeme Young
Evaluate Festival	Gather feedback from 2014 participants in order to gain a better understanding of how to improve on 2014 festival	2014-2015	Yes	FOEBR Committee and members
Plan for Festival in 2015	Work with YRC officer, Sarah Fowler, and FOEBR members to discuss theme, stall holders, school involvement & community groups, food etc.	Feb-Oct 2015	Yes	FOEBR Committee

Apply for funds	Chelodina Festival grant applied for from YRC for 2016 event	June 2015	Yes	Sally De Visser
Promote 2015 Festival	Advertising	Sep – Oct 2015	In Hand	Graeme Young Sally De Visser
Wait and See!	Grant Application successful for \$2,000	Oct 2015	Yes	Sally De Visser
Chelodina Festival	Event held at Elizabeth Bridge Reserve	15 Nov 2015		FOEBR Committee
Plan for Festival in 2016	Refer 2015 planning	Feb-Oct 2016		FOEBR Committee
Evaluate Festival	Gather feedback from 2015 participants in order to gain a better understanding of how to improve on 2015 festival	2015-2016	Yes	FOEBR Committee and members
Plan for Festival in 2017	Refer 2016 planning	Feb-Oct 2017		FOEBR Committee

## Kilsyth Off Leash Dog Park

People Power	Engage like minded people	2014-2015	Ongoing	Dan Jones
Identify similar groups	Contact Friends of Manningham Dogs And Cats, Whitehorse Owners Of Family Friendly Dogs Association, and Croydon & District Obedience Dog Club	2014-2015	Yes	Shelley Large
Find the Spot	<ul style="list-style-type: none"> <li>Decommissioned former Yarra Hills Secondary College oval, Cambridge Rd (PREFERRED VENUE)</li> <li>Investigate alternative sites</li> </ul>	2014	Ongoing	Shelley Large
Lobby State Government	Online and hard copy petition delivered to James Merlino MP Monbulk	2015	Yes	Shelley Large or John Willis
Lobby YRC to accept gift of the oval from State Government	Use contacts gained through YRC Community Planning	2015	Ongoing	Shelley Large
Fence off the site	Work with YRC to gain use of site for Kilsyth Dogs and Owners	2015-2016	Ongoing	Shelley Large
Design and landscape the site	Recommend council staff use PAWS FOR PLAY Unleashed-A Guide to Successful Dog Parks (SA Govt. publication)*	2016	Ongoing	YRC staff & key players of KOLDP
Gain funds	Apply for Council grant/crowd funding	2016-2017		KOLDP
Official Membership Group	Incorporation	2018-2020		KOLDP

\* **PAWS 4 PLAY** is committed to helping councils and dog owners to work together to provide well-planned opportunities for dogs and their owners in the community

\*\* At this stage of the plan things become more fluid, depending on decisions the YRC makes. E.G. If YRC decide Kilsyth Off Leash Dog Park Group must share the facility with a sporting group, toilets, off street parking and a club house become more feasible. If we are given sole use then the design and play equipment become a bigger focus. If offered a different site then the group's plans will respond to the requirements of the site.



## Appendix 1: THE KILSYTH COMMUNITY PLAN BIG IDEAS REGISTER

This spreadsheet outlines all ideas gathered throughout the engagement and workshop process, how the ideas address the themes and where those ideas might fit within the proposed projects. Similar ideas have been merged to condense the information.

**DOTS:** How many dots this idea received at all consultations

**WALK:** Kilsyth Walk - Heritage Walking Trail

**TOWN:** Kilsyth Common & Town Centre

**FEST:** Chelodina Festival

**DOGS:** Kilsyth Off Leash Dog Park

**LATER:** An idea that doesn't currently fit with the projects planned, but acknowledged for future reference

KILSYTH COMMUNITY PLANNING BIG IDEAS REGISTER	DOTS	WALK	TOWN	FEST	DOGS	LATER	OTHER	NOTES
<b>Communications</b>								
Local newspaper	4							Local business
Kilsyth Chamber of Commerce								May emerge
Community noticeboard at shopping centre	5							One already at the Reserve
Schools as a place to gather and share information / build awareness of schools	4							Will happen as part of the projects
Website or Facebook page							DONE	Need more people to post
Newsletter	3						Japara L&LC	Planned
Heritage walking tour of Kilsyth's treasures	11							Subcommittee established
Signage	2							More details needed

KILSYTH COMMUNITY PLANNING BIG IDEAS REGISTER	DOTS	WALK	TOWN	FEST	DOGS	LATER	OTHER	NOTES
Icon / brand for neighbourhood	4							Chelodina turtle? Design competition? Mural?
<b>Vulnerable Groups</b>								
Compile a list of local services	1						YRC Community Directory	Promote this resource in the newsletter
Community meals	2							Lacks an initiator
Montrose	3						Montrose & Mooroolbark	Promote these resources in the newsletter?
<b>Older People</b>								
Engage with people in their homes	7						Vic Pol	Community Safety Register
Mentoring project								Engagement with local history
Intergenerational project	4						Japara L &LC	Schools projects & intergenerational exercise
<b>Identity / Community / Heart / Gathering Place</b>								
A centre... A heart ... (of Kilsyth)	6							Town Centre Subcommittee
Town square								Town Centre Subcommittee
Improve the shopping / parking area - Kilsyth / Churinga / pedestrian access / amenity / place to gather / sit	35							Town Centre Subcommittee
Outdoor dining areas / café culture	7							Town Centre Subcommittee
History of Kilsyth	6							Kilsyth Walk Subcommittee

KILSYTH COMMUNITY PLANNING BIG IDEAS REGISTER	DOTS	WALK	TOWN	FEST	DOGS	LATER	OTHER	NOTES
Community garden(s)	7							Attract initiator
Arts projects	3							Community Planning Group
Community events/festival	6							Chelodina Festival
Community market	8							Chelodina Festival
Clean up green areas - Clean up Kilsyth day	2							Attract initiator
Kilsyth "identity" - people outside Kilsyth don't know where it is								Town Centre Subcommittee Kilsyth Walk Subcommittee
Many hearts of Kilsyth - how to connect them?	3							Kislyth Walk
Bring community together	7							All projects
Opportunities to stay in Kilsyth for entertainment	2							Ongoing
Use Memorial Hall more								Community Planning Group
Tap in to new people moving in .. Welcoming committee!								Attract initiator
Challenge perception that you just drive through Kilsyth								Town Centre Subcommittee Kilsyth Walk Subcommittee
Chelodina Festival	2							Nov-15
Library							Japara	Montrose & Moo
Music in the park								Chelodina Festival
To join together and become a large effective team – “Team Kilsyth”								Community Planning Group
Connect sporting clubs								Kilsyth Walk Subcommittee Sporting Club Management
Walking group / trails	8							Kilsyth Walk Subcommittee

KILSYTH COMMUNITY PLANNING BIG IDEAS REGISTER	DOTS	WALK	TOWN	FEST	DOGS	LATER	OTHER	NOTES
Off leash dog park	13							Unleash Subcommittee
Signage needed about dogs on leads in parks								Unleash Subcommittee
Recreation opportunities for families								Town Centre Subcommittee Kilsyth Walk Subcommittee
Adult exercise park	9							Possible at Kilsyth Common
Lawn bowls behind Churinga			?					Possible at Kilsyth Common
BIG community playground			?					Possible at Kilsyth Common
Improve swimming pool	5						YRC	Currently in development
More play equipment for children	2		?				YRC	Currently in development
<b>Young People</b>								
Youth hub / skate park	14							Attract initiator
Youth forums	2						Youth Services?	Define the idea
Schools sharing facilities/projects							SFYS	Gladesville, Pembroke & Kilsyth PS sharing projects
Playgroups							Japara L&LC	Grandparents playgroup
Toddler group	2						Japara L&LC	
More things for kids	5						Japara L&LC	
Gocart race day								Attract initiator
Teach children how to garden							Japara L&LC	Adult classes at Japara
<b>Education &amp; Learning</b>								
Community classes	3						Japara L&LC	



KILSYTH COMMUNITY PLANNING BIG IDEAS REGISTER	DOTS	WALK	TOWN	FEST	DOGS	LATER	OTHER	NOTES
<b>ENVIRONMENT</b>								
No smoking areas	1							
More organic shops and veggie gardens on nature strips								
Clean up median strips								
Messy								
Cut back foliage over footpaths								
<b>BUSINESS</b>								
A fun park							Business invest	
Dreamworld in Kilsyth							Business invest	
Support for thriving economic development								
<b>DEVELOPMENT / PLANNING</b>								
Do not develop	2							
Slow down with sub dividing blocks	12							
Keep Kilsyth green								
One Council looks after Kilsyth								
Area opposite primary school is an eyesore with long grass – never mown.							YRC?	Which school?
Pools and parks	2						YRC	
Toilet block removed or upgraded from corner of Durham an Mt Dandenong Rd	4						YRC	tba
Kilsyth PS car park upgrade – not safe	2						Education Dep	
More concrete footpaths	13						YRC	

KILSYTH COMMUNITY PLANNING BIG IDEAS REGISTER	DOTS	WALK	TOWN	FEST	DOGS	LATER	OTHER	NOTES
More open spaces							YRC	Pembroke oval retained
Lower rates, more hard rubbish							YRC	
Footpaths on Durham Rd leading to Elizabeth Bridge Reserve from Collins Place							YRC	Infrastructure tbc
New playground at Pinks Reserve near football club	2						YRC	
Urban design							YRC	
Dinosaur enclosure							Business invest	
Train station - better public transport							STATE GOV	
Mini esplanade							?	
More police presence - Eg. Speeding vehicles							STATE GOV	
<b>ROADS</b>								
Remove barricade beside Churinga to stop traffic congestion							?	Town Centre Subcommittee
Better roads							VICROADS / YRC	
Too many traffic lights							VICROADS	
The traffic lights at Durham and Mt Dandenong Rd. Too many cars get caught in the middle of the intersection stopping traffic							VICROADS	

## Appendix 2: AN INVENTORY OF IDEAS

The project ideas below were gathered in workshops from August – November 2014. They indicate the depth and breadth of opportunity for projects that might arise from the community planning process and offer a glimpse in to how the plan evolved. These ideas were displayed on large posters at the Chelodina Festival in December to seek feedback and welcome new ideas from the community.

### Kilsyth Common and Town Centre Project

- Suggestion box
- Community notice board
- Community market
- Area between 2 shopping centres – opportunity for a place for community to gather?
- Approach owner to sell or lease property in the middle of the centre for use by community
- Planter boxes closing Russo St to be updated and provide rubbish bin
- Safety of eastern exit to Coles car park
- Line marking and directional arrows in both car parks
- Link both car parks with a through lane
- Erect Churinga Shopping Centre signage on Mt Dandenong Rd
- Rubbish bins duplicate Croydon Main St – possibility of ward funds from Len Cox if acted on quickly
- Address flooding outside Woolworths on footpath area
- Rubbish removal in trolley bays
- Beautification and greening between the two shopping centres
- Caretaker to be employed to ensure ongoing cleanliness
- Traders association creation?
- Future of the tennis club?

### Walking Map of Kilsyth's Treasures

- Bridge Reserve
- Joining all parks together via tracks
- Historical markers along the tracks
- Melbourne Tapscott Reserve (Brick Works)
- Jean Bridge (source of history of Kilsyth)
- Sue Thompson (source of history of Kilsyth)
- Advertise via:
  - Brochures
  - Computer print yourself
  - Notice board
- Research:
  - Turner (artist) lived cnr. Colchester and Mt Dandenong Rd
  - St Richards for assistance (Debbie Jones)
- Kilsyth & Gladesville Primary School

- Memorial Hall
- Old Houses
- Colchester Dairy – Farm?
- Staging post for horses
- Old photos
- Dongala Homestead
- Whiteboard on which people write ideas and have their photograph taken with it.  
(people check the web site to see themselves and learn / join in the conversation)

## Off Lead Area for Dogs

### What:

- Circular open space
- Promote social interaction for dogs and their owners (eg if someone is sick people will walk their dogs for them)
- Fenced
- Club house
  - Education for dogs (eg obedience classes)
  - Meeting place
- Dog festival
- Sharing resources
- Shade, water for dogs, seats
- Signage – way finding signage

### How:

- Find the right spot
- Link in with Council / consultation
  - Knox
  - YRC
  - Maroondah
  - Yarra Hills disused school oval
- Community backing – go out to community and gather support

### When:

- Go to the community 6 months
- Involve YRC and/or neighbouring Councils 6 – 12 months
- Identify appropriate spot 12 – 18 months
- Design etc 24 months

### Who:

- Kilsyth dog owners
- YRC
- Local laws
- Rec services
- Animal Aid
- Maroondah and Knox Council

**Why:**

- Improve health
- Reduce diabetes
- Increase social connectedness
- Increase physical activity
- Well socialized and balanced dogs – less dog attacks

**Footpaths****What:**

- Mountain View Rd footpath – important to residents (particularly older adults). Connects where people live to shops precinct
- Russo Place footpath improvements required. Raised pavements
- Elizabeth Bridge Reserve through school site trail important. Connects school community to park and where people live.
- Connect parks via trails and footpaths
- Crossing Durham Rd to Japara Living and Learning Centre
- Vegetation pruned back of footpaths

**How:**

- Consider proposals as part of Kilsyth PPN(?) – scope in 2014 / 2015

**Who:**

- YRC
- Partner local traders in improvements on shops precinct

**Community Market****What:**

- Showcase
- Arts
- Commercial / Home based business
- Sports
- Accessible
- Twilight
- Carboot?
- Veggie?
- Craft?
- Does it make \$\$?

**Where:**

- Hansen Park
- Japara
- Between the 2 shopping centres @ Churinga
- Rotating?



**When:**

- 1 x monthly
- Seasonal - 4 x a year (not at Japara in Winter)

**Who:**

- Japara Living and Learning Centre
- Umbrella body
- Schools & kinders
- Performance
- Host? EOI
- Walmsley? (Manage?)
- Rotary?

**Why:**

- Activate empty land
- Different venues – get to know/showcase the area
- Community connections

**Spin offs:**

- Community veggie garden
- Trade and sport expo
- Arts projects
- Promote walking trail

**Kilsyth Community Festival & Trade and Sports Expo**

- Embrace many groups:
- Trade – provide cash / info
- Sport – active stands
- Schools
- Various clubs
- Farm fare
- Mature age groups
- Children's activity
- Food stalls

## Appendix 3: SUMMARY OF COMMUNITY SERVICES

An audit of Kilsyth's services shows that the area is well serviced by primary schools, retail, a wide variety of major and community sporting facilities and a dynamic community house. Other services are located in the surrounding suburbs. There are no high schools in Kilsyth.

Post Office	1
Retail businesses (e.g. supermarket, newsagent, drycleaners, etc.)	50+
Police Station	0
Childcare	2
Kindergarten Programs	2
Public Primary School	2
Catholic Primary School	1
Secondary School	0
Tertiary Education	0
Library - Outreach Service	1
General Practitioner Clinic/s	3
Dental Practices	
Allied Health Practices	
Community Education (Japara & Yarra Ranges U3A)	2
Aged Care Facilities	3

### Japara Living & Learning Centre

Japara Living & Learning Centre has been serving the community for over 35 years and provide an important community resource. Japara offers high quality and affordable educational and recreational programs, providing a number of ways for the community to build social connections.

Japara's main office is located in their new, purpose built, five-star Living & Learning Centre in Kilsyth. You can join a social club, bring your children to their occasional child care or playgroup, drop by to have a rest and read a book in their community library, or enrol in one of their popular courses or workshops.

Japara is committed to offering the community up-to-date resources and encourages everyone living in Kilsyth to stop by and talk to their friendly staff. Everyone is welcome!

## Sport and Recreation Facilities

### Pinks Reserve Precinct

The picturesque Pinks Recreation Reserve complex is a major sporting precinct consisting of an indoor stadium, sports ovals, and a regional netball facility. Each week badminton, netball, table tennis, basketball, softball, football and cricket competitions attract thousands of local people and visitors to the area. In addition, many take advantage of the marvellous scenery to take their daily walk in its environs.

### Kilsyth Football Club

Kilsyth Football Club has been an important part of the local community for over 90 years. It started life in 1924 as a member of the Ferntree Gully-Croydon League. Later, in 1962, it became a foundation affiliate of what is now the Eastern Football League (EFL), which is widely regarded as the premier metropolitan league in Australia. The Club's nickname is the Cougars and the team colours are black jumpers with a red sash.

The Club caters to several generations of interest in Australian Rules football. Each weekend during the season it hosts the Gladesville/Kilsyth AUSKICK for primary school children, and fields nine junior teams (under 8s, 9s, 10s, 11s, 12s, 13, 14s, 15s and 17s), three senior teams (Seniors, Reserves and under 19s) and a Veterans team.

This represents a total playing strength of some 300 men, girls and boys, plus of course their families, club members, and many supporters ... all in all, quite an operation.

In the course of its long history, Kilsyth teams and players have won many awards and achieved many successes. The club's tradition boasts seven senior premierships, as well as numerous Reserve, Under 18 and Junior and Veterans flags.

### Kilsyth Cricket Club

Kilsyth Cricket Club was formally established in 1922 when it joined the Ringwood District Cricket Association (RDCA). It holds the distinction of being the only RDCA affiliate that has fielded at least one team in every season of competition since that inaugural season.

Kilsyth, known as the Redbacks, has won the most top grade First XI premierships in the RDCA, having won a total of 63 premierships in its history across all grades in its Senior, Junior and Veteran divisions.

The Club has grown to the point that it fields seven senior teams, five junior teams (from under 10s to under 18s), and has also boasted a Veterans team.

It is proud of its record and reputation of being a well-respected and long serving member of the Association.



## Lillydale & Yarra Valley Netball Association



The Lillydale & Yarra Valley Netball Association (LYVNA) was formed in 1979 and has since grown to 23 clubs, 200+ teams and over 2000 players, umpires and coaches. Since 2015 the LYVNA has been located at Pinks Reserve Regional Netball Facility.

Member clubs are based in the outer eastern suburbs and Yarra Valley areas including Lillydale, Mooroolbark, Chirnside Park, Kilsyth, Montrose, Mt Evelyn, Wonga Park, Croydon, Croydon Hills, South Croydon, North Croydon, Coldstream, Seville, Launching Place, Yarra Glen, Healesville and Kinglake.

The philosophy of the LYVNA is to provide a program designed for beginners to advanced players, coaches, umpires and administrators who want to develop their skills and knowledge of the game whilst maintaining a sense of fun and enjoyment.

The LYVNA is affiliated with Netball Victoria and therefore follows their policies and guidelines such as Junior Policy, Risk Management and Member Protection.

## Kilsyth Sports Centre

The Kilsyth Sports Centre is an amalgamation of basketball courts (6), badminton courts (12) and table tennis courts (30). The Centre is owned by Yarra Ranges Council.



## The Kilsyth and Mountain District Basketball Association Inc.

K&MDBA was established in 1963 to promote and control basketball in Kilsyth and surrounding districts, principally by conducting competitions for Basketballers registered with the Association. Today Kilsyth Basketball is the largest Basketball Association in Victoria, responsible for over 1,050 domestic Basketball teams with over 14,000 registered players playing the game of Basketball each week in its venues and competitions.

The Kilsyth Sports Centre is the home of the Kilsyth Cobras who are the representative teams of Kilsyth Basketball. At the senior level teams compete in the prestigious men's and women's sections of the South East Australian Basketball League and also field men's and women's development teams in the Victorian Youth Championship Competition. The Association also has numerous junior boys and girls representative teams competing in the Victorian Junior Basketball League competitions.

## Lilydale Ejays Softball Club

Ejays is a family oriented organisation which encourages and welcomes participation by mums, dads, aunts, uncles, grandparents, siblings, partners and other family and friends in all facets of our club and our sport.

The Club began in 1982 at the Keith Hume Fraser Reserve on Swansea Road. Council later established a softball diamond at Pinks Reserve, moving the redundant Healesville Visitor Centre building to the site which serves as a club room. Lilydale Ejays strive to ensure that:

- communication is open and free flowing between its members and committee;
- members are actively involved in significant decisions affecting the club;
- members' health and safety is foremost in all decision making;
- the committee acts responsibly in the financial management of the club;
- members are supported in their attempts to achieve their maximum potential within the sport; and,
- members get the greatest possible enjoyment from their sport.

Lilydale Ejays teams represent broad skill levels, from the complete novice to the elite athlete. The Club has enjoyed many successful seasons and seen a number of players reach extraordinary heights. Several female players have received scholarships to train and play overseas, and one of the male players is currently the State Men's Open Team captain. A number of players have been in State and National teams.



## Kilsyth Centenary Pool

Kilsyth Centenary Pool is an aquatic facility that provides swimming lessons, aqua aerobics, boot camp and general lap swimming to all members of our community including Kilsyth, Croydon, Mooroolbark, Bayswater and surrounding suburbs.

Kilsyth Centenary Pool boasts a 50 meter swimming pool, spa, toddler pools, 25meter outdoor swimming pool and toddler pool.

## Aged Care Facilities

Dutchcare  
Kirkbrae Presbyterian Homes  
Australian Unity (Walmsley Friendship Village)

Mt Dandenong Road  
Mt Dandenong Road  
Greeves Drive



## Appendix 4: KILSYTH OFF-LEASH DOG PARK PROJECT PLANNING

*Our vision for Kilsyth is a dedicated off lead dog park. Our vision is the ultimate and it may be many years (up to 10years) before the ultimate is possible!*

The park and clubhouse would promote and facilitate responsible dog ownership and the benefit of animal companionship focusing on the legitimate needs of pets and their owners while respecting the rights of other members of the community and protecting the environment.

The Kilsyth Off Leash Dog Park would be good for dogs. Socialisation is so important for a well behaved dog. Further, the mental health of owners cannot be underestimated. Caring for a dog gives purpose to the life of an elderly, lonely or disabled person and walking means a healthier body. The social interaction gained by meeting other like minded people is enormous.

### **Location:**

- It should be within walking distance of as many homes as possible, along existing walking trails, tracks, and footpaths and not isolated.
- It should have an ambient environment with trees, shelter and shade.
- The oval adjacent to Elizabeth Bridge Reserve would be ideal.

### **Securely Fenced:**

- The park would need to be fenced in order for owners to confidently teach and practise their dogs the recall, and allow dogs the freedom to run and play in safety.

### **Amenities:**

- Bins and poo bags
- Fixed agility equipment
- A Club House used for educational and social activities would make it perfect!
- Free obedience classes
- Educational information sessions, e.g.,
- how to stop barking
- how children should greet a dog
- An emergency dog walking co-op for sick or hospitalised locals
- Adequate parking with particular attention to the needs of the elderly and the disabled.
- Drinking water for dogs and their owners (a water fountain)
- Flood Lights for safety at night and winter use.

### **How:**

- **See KILSYTH OFF LEASH DOG PARK ACTION PLAN**

## Appendix 5: URBAN DESIGN CONCEPTS

### Concept 1 Options for improving connection to Greeves Drive



Greeves Drive entrance to pathway to Kilsyth Shopping Centre

The shelter and corner allotment belongs to Yarra Ranges Council. It is planned to remove the gate and open up the view and entry to the park area

#### What further needs to be done?

Yarra Ranges Council is developing options for consultation with the community

### Concept 2 Realign existing path to reduce slope and improve accessibility

In order to improve safety, realign path to shops from Greeves Drive and beautify (eg. plants, artwork, sculptural elements)

#### What further needs to be done?

- Yarra Ranges Council is developing options for consultation with the community
- Community views to be canvassed in deciding how to beautify
- This point of interest will be included on the route of the proposed Heritage Walking Trail



Pathway from Walmsey Retirement Village to Kilsyth Shopping Centre

### Concept 3 In the event that Kilsyth Tennis Club relocates to Mooroolbark Tennis Club:

- Open up space between Eastern Ranges oval and the rest of the Reserve
- Re-design existing tennis court area to incorporate passive play area & open
  - Recreation space
  - Examine feasibility of use of clubrooms as, for example, a coffee shop

#### What has been achieved?

- Council presently maintains the grass around the tennis courts
- Plans are in train for the move of the tennis club



Kilsyth Tennis Club

### What further needs to be done?

- Finalisation of the tennis club's relocation
- Consider retaining a number of the tennis courts for public recreational use
- Re-develop remaining area as passive play / open space
- Community involvement in how to best use the precinct (eg. Community design competition)

### Concept 4 Closing off access path to rear of shopping centre

There is a small path that leads from the park to the loading bays of Woolworths and Aldi shopping centres. It is proposed to investigate preventing access for reasons of safety and aesthetics

#### What further needs to be done?

- Investigate ownership of land and seek information from Churinga Management for the need for access between park and loading bay (ie., if any safety reason).
- Determine cost of blocking access



Pathway behind Churinga Shopping Centre with mural detail

### Concept 5 Improve ramp and widen pedestrian path

The path leading up to the Coles and Churinga shops from the park is proposed to be widened for safer and more stable access (especially for older residents with walkers, prams, shopping trolleys)



Rear entrance ramp to Churinga Shopping Centre

### Concept 6 Upgrade and re-design brick enclosure housing water valves

The current enclosure is an eyesore in need of repair – brick wall is cracking. A more modern protected enclosure would be more appealing and less attractive for unauthorised access

#### What further needs to be done?

- Determine who controls this area (ie. Yarra Valley Water, MFB)
- If still a functioning requirement, seek solutions in collaboration with the owners to re-develop and protect the equipment



Water mains enclosure



**Concept 7** Beautification of shop fronts – including private land between the Churinga and Coles complexes

Give this central hub of Kilsyth a ‘face-lift’ and aim for uniformity of appearance, tidiness, ease of parking, ease of access – creating a space where locals and visitors are inspired to gather, shop and socialise.

**What has been achieved?**

- There has been some consultation with the owner of the vacant land concerning community use.
- Kilsyth Football Club conducted a clean up of the area to clear the block of unkempt growth and unlawfully dumped debris.
- Churinga Centre Management is responding to community approaches for installing larger rubbish bins. Plantations near Australia Post have been completed, drainage has been improved, and garden toppings have been laid in carpark edging.



Vacant block in the middle of the Kilsyth Shopping Precinct before clean up



Vacant block in the middle of the Kilsyth Shopping Precinct after clean up

**What further needs to be done?**

- Community consultation on ideas for the beautification of Churinga and Coles Shopping complexes (e.g., standardised façade, wider walk-ways, removal of pot-holes and well-maintained parking and road areas, possible mural for Coles side-wall, use of floral displays).

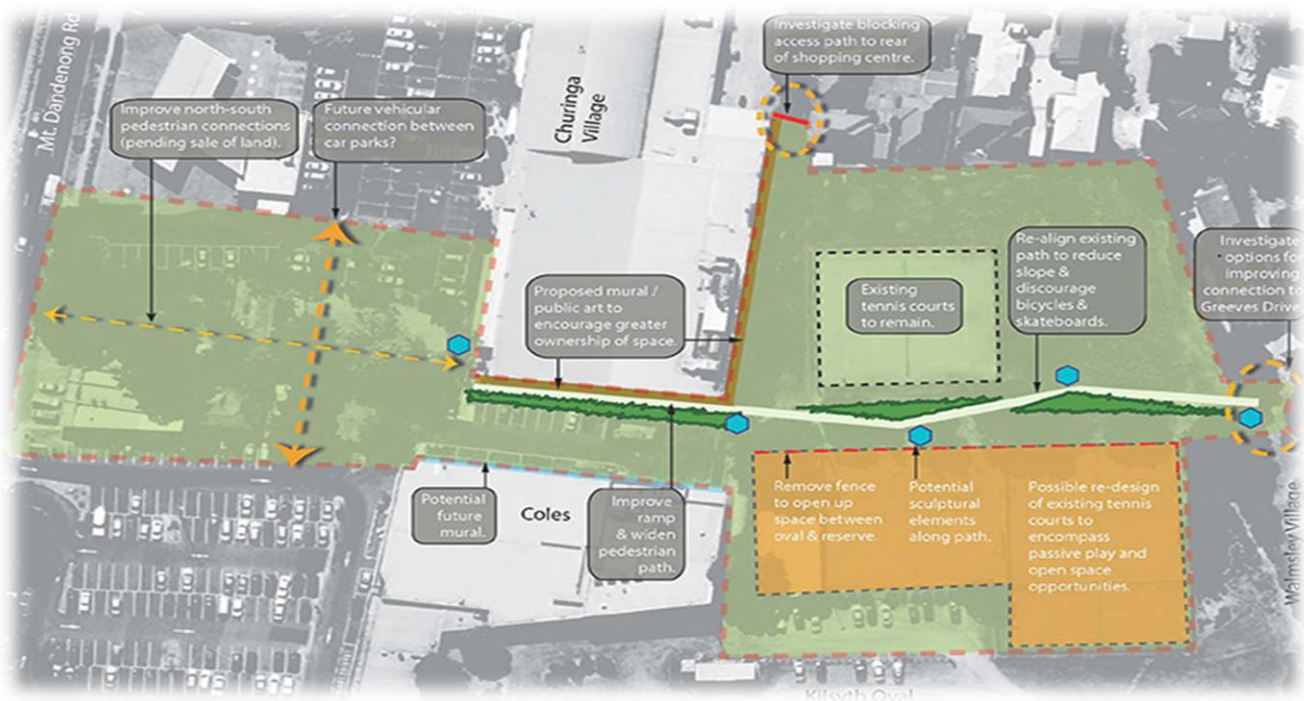

Urban design concepts by Pollen Studio

## Appendix 6: KILSYTH COMMUNITY SURVEY SUMMARY

- The Kilsyth community survey was conducted over 4 events:
  - Chelodina Festival (Bridge Reserve)
  - Kilsyth Shops Community Consultation
  - Kilsyth Sports Centre Consultation
  - Online Survey (SurveyMonkey)
- Total of 132 responses (incl. 16 online)
- 70% of respondents lived in Kilsyth
- 80% of the respondents planned to be living in Kilsyth or the surrounding region for the foreseeable future (7 years or more).
- Anecdotally a large number of those from outside Kilsyth lived close by and used Kilsyth’s assets.
- The survey, unfortunately did not engage well with younger residents. This is something that will be taken in to account for future Community Planning activities.
- There were a total of 8 questions on the survey focusing on:
  - Demographics data
  - How can Kilsyth be enriched
  - What to change in Kilsyth
  - What to retain in Kilsyth
  - Which current community projects to support

### Response results for each question asked:

#### Age Category ...

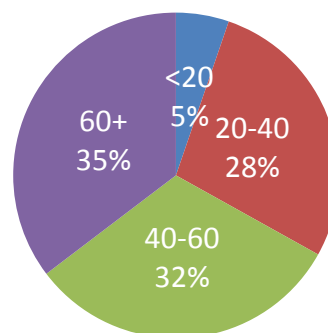
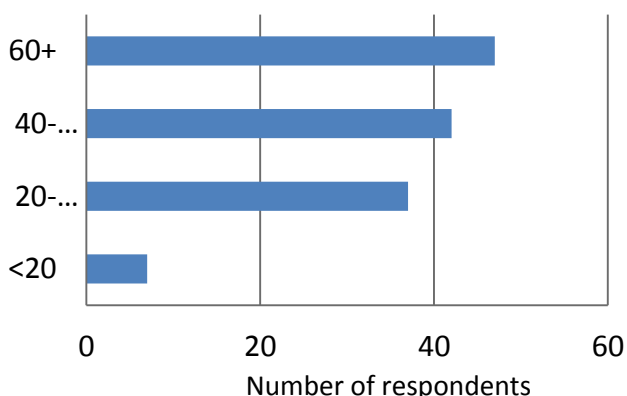



## Kilsyth could be enriched by ...

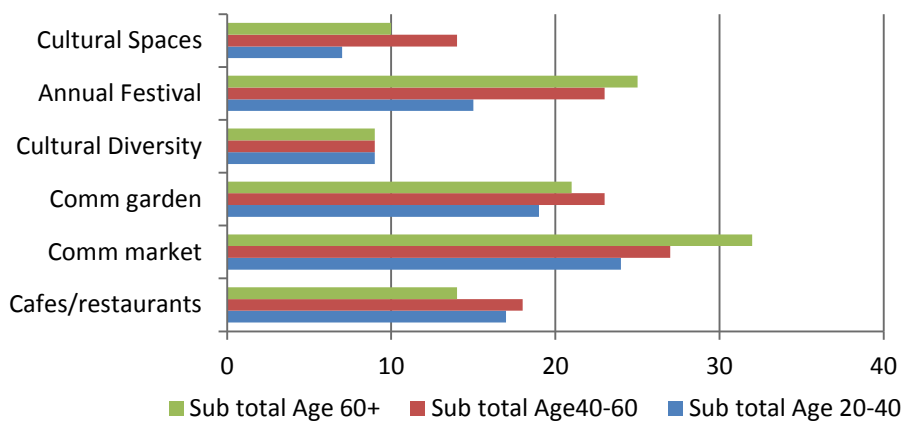
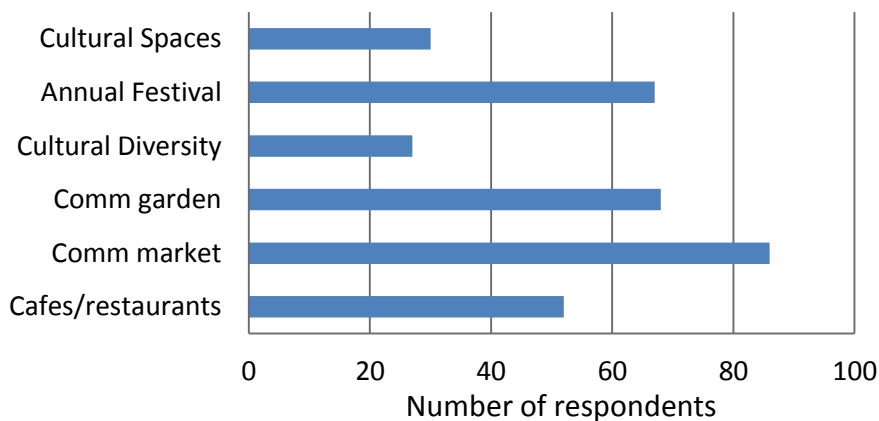

## Other feedback from respondents about enriching Kilsyth

- Walking track
- No more units
- Community market in the EB Reserve
- Cleaner shopping centre carpark
- cut down the amount of dual occupancy in Kilsyth
- less units taking away from the green areas trees shrubs and creating traffic therefore polluting. I know nothing will change
- Encouraging youth in music performance
- Parks; dog walking areas
- Venue for single men over 30 ; meeting place for friendships without joining a club
- Children's playground
- Better public transport
- Like the Elizabeth Bridge Festival
- More walking reserves with toilets and eating areas
- Clean up areas - parks, etc. - "I walk dogs in parks"

### Should change in Kilsyth ...

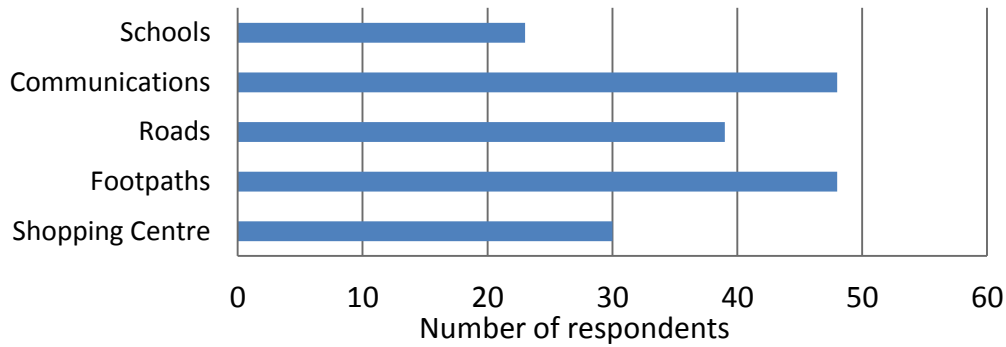

### Other feedback from respondents about things to change in Kilsyth

- I would like to see the shopping centre from Coles to the Bakery cleaned up and receive new fascia
- Stop the sub division in Kilsyth or will end up a slum area & nothing but a concrete jungle.
- The roads are so congested and speed will cause accidents
- More seats in the park
- Happy the way thing are
- A park in the shopping centre
- Opening up the two carparks
- One of every sort of shops - e.g., not 3 bakeries or 3 \$2 shops
- Footpath required in Pleasant St.; also main road light going into Pleasant St from Liverpool Road as hard to find corner as light is in wrong place
- Free WiFi areas

### Should retain in Kilsyth ...

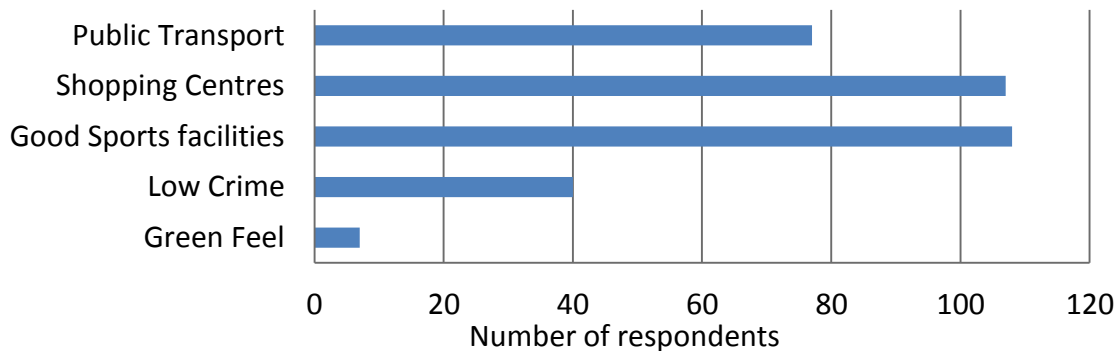

## Other feedback from respondents about things to retain in Kilsyth

- Have water & bags at entrance to reserve
- Maintain a quiet outdoor environment with lots of trees could use more trees
- Public transport drivers are nice people we are lucky to have them
- Better parking in Churinga-one way system into the Aldi/ Woolies car park
- No big shopping centres; just as is
- More policing; more seating areas

## Support for proposed projects ...

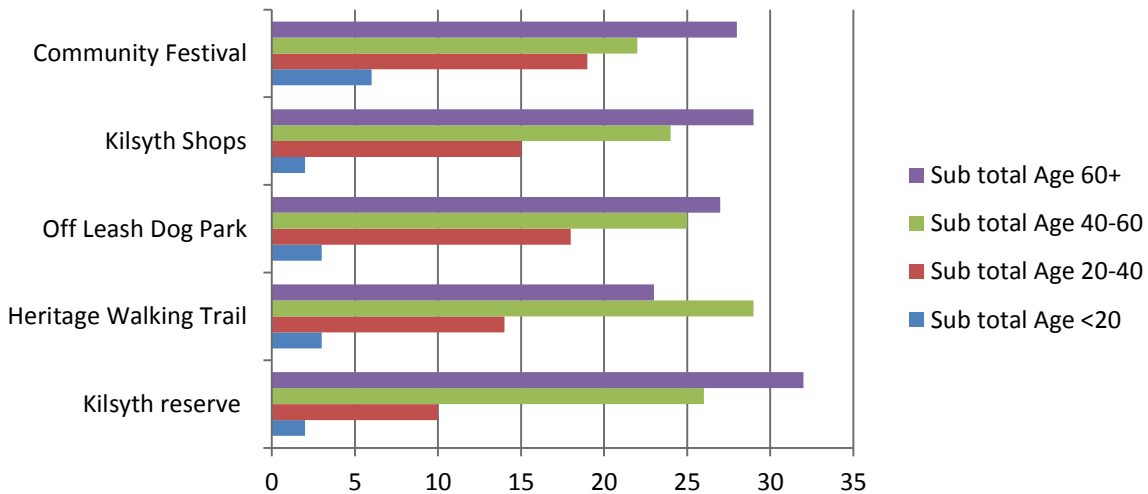

## Appendix 7: SHOPPING PRECINCT TRADER ENGAGEMENT SUMMARY

Visits by **Neil Cameron/Mike O'Meara** to around **41 traders** (all those open for business) on Thursday 12 November 2015 in Churinga and Kilsyth shopping centres and shops in Colchester Road.

### Process

The visits were preceded by a letter/email of introduction to business and property owners whose contact details were known via Yarra Ranges Council. The team moved from shop to shop, meeting occupants who were variously owner-operators, business managers, or staff.

### Purpose

To advise traders about the Kilsyth Community Planning process, including:

- How community consultation had identified this retail precinct as a priority focus
- How relevant initiatives that had already been implemented through community action (for example, obtaining new rubbish bins, drainage improvements, clean up of vacant block)
- A copy of the 'Nutshell' document was left with each to study at their leisure, with an explanation that this was not a one-off visit, but more of an introductory encounter and that there would be subsequent visits.

To ask traders if they had any particular issues, concerns, ideas they wanted to share\*.

### Summarised feedback

- Traffic hazards
  - maintenance of car park surface and directional arrows
  - unsafe main entrance/exit point in Coles car park (likely to be exacerbated with completion of new apartment block being developed directly opposite)
  - parking on Mount Dandenong Road obscuring vision when exiting Coles car park (near Allans Bakery)
  - Need for internal access link between the two shopping centre areas
- Need to upgrade shop facades in the Coles shopping centre block
- Security issues
  - lighting (shift workers)
  - CCTV cameras
- General cleanliness of the precinct, and of the Coles public toilets in particular
- Need for wider footpaths (esp. catering for aged pedestrians who often use walkers/motorised scooters – also to permit space for planter boxes, outside seating, etc.)
- Need for more greenery/dressing up to introduce a cafe culture feel .

Overall, traders were pleased that the planning process was happening, and to be given the opportunity to contribute. They were advised they are viewed as critical stakeholders in the process, and informed about the intention to organise a traders' meeting – e.g., *Mainstreet Australia* seminar – in the early part of 2016.

*\* Some responses fell outside our charter (though provided useful intelligence). For example, their views on the effectiveness of their respective property managers.*

## Appendix 8: REFERENCES & FURTHER READING

- Kilsyth Community Connections Facebook page:** <https://www.facebook.com/kilsythcommunityevents?fref=ts>
- Australian Bureau of Statistics (2006) *Census of Population and Housing:*** [www.abs.gov.au](http://www.abs.gov.au)
- Australian Government, Department of Sustainability, Environment, Water, Population and Communities, Threatened Species & Ecological Communities:** <http://www.environment.gov.au/biodiversity/threatened/>  
(accessed July 2011)
- Kilsyth Primary School History of:** [http://www.kilsythps.vic.edu.au/text/school\\_history\\_b3q5.htm](http://www.kilsythps.vic.edu.au/text/school_history_b3q5.htm)
- Melbourne Water, Liverpool Road Retarding Basin – Site of Biodiversity Significance:** [http://www.melbournewater.com.au/content/rivers\\_and\\_creeks/our\\_programs](http://www.melbournewater.com.au/content/rivers_and_creeks/our_programs)
- Metlink:** <http://www.metlinkmelbourne.com.au/>
- Monash University, *Australian Places Gazetteer*, National Centre for Australian Studies:** <http://www.arts.monash.edu.au/ncas>  
(site now decommissioned)
- Railtrails Australia:** <http://www.railtrails.org.au/>
- Ventura Bus Service:** <http://www.venturabus.com.au>
- Wikipedia:** <http://en.wikipedia.org>
- Japara Living and Learning Centre:** [www.japarahouse.com.au](http://www.japarahouse.com.au)
- Kilsyth Football Club:** [www.kilsythfootballclub.com.au](http://www.kilsythfootballclub.com.au)  
[www.facebook.com/kilsythcougars](https://www.facebook.com/kilsythcougars)
- Kilsyth Cricket Club:** [www.kilsythcc.vic.cricket.com.au](http://www.kilsythcc.vic.cricket.com.au)
- Lilydale and Yarra Valley Netball Association:** [www.foxsportspulse.com/assoc.cgi?c=191-0-0-0](http://www.foxsportspulse.com/assoc.cgi?c=191-0-0-0)  
[www.vic.netball.com.au](http://www.vic.netball.com.au)
- Kilsyth Basketball:** [www.kilsythbasketball.com.au](http://www.kilsythbasketball.com.au)
- Kilsyth Diamond Softball Club:** [www.kilsythdiamonds.softball.org.au](http://www.kilsythdiamonds.softball.org.au)
- Lilydale Ejays Softball Club** <http://ejays.softball.org.au/>
- Mountain District Badminton Association:** [www.insports.com.au/mdba](http://www.insports.com.au/mdba)
- Croydon and District Table Tennis Association:** [www.insports.com.au/ttv/cdtt](http://www.insports.com.au/ttv/cdtt)
- Kilsyth Centenary Pool:** [www.kilsythcp.com.au](http://www.kilsythcp.com.au)
- YRC Community Directory:** <http://www.yarraranges.vic.gov.au/Community/Search-the-community-directory>





The Great Wall of Kilsyth – Image Angela Rivas, Lunasol Photography



be inspired  
have your say  
get involved



Creating a happy Kilsyth

[www.kilsythcommunity.wix.com/getinvolved](http://www.kilsythcommunity.wix.com/getinvolved)