

SECTION: WELDED WIRE MESH FENCING WITH GALVANISED STEEL POST

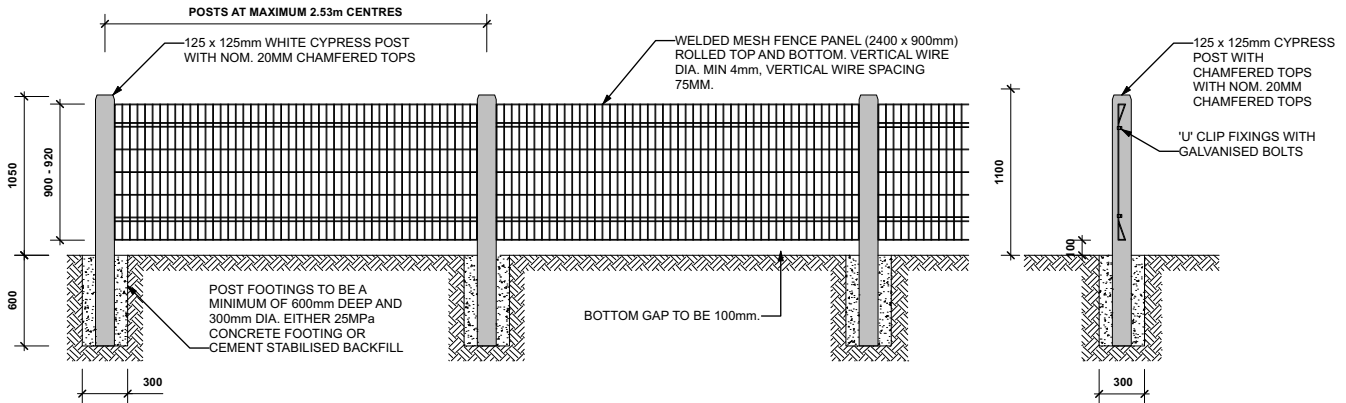

SECTION: WELDED WIRE MESH FENCING WITH TIMBER POST



(images are illustrative only and do not override other information provided)

NOTES

- TIMBER SHOULD BE GOOD QUALITY AND GENERALLY FREE FROM SPLITS AND DEFECTS. LIGHTLY SANDED BACK WITH EXPOSED EDGES ROUNDED OFF.
- TIMBER SHALL BE LEFT RAW. NO PAINT OR STAINS ARE TO BE APPLIED
- FENCE PANEL SHOULD BE AT A MINIMUM OF 100mm ABOVE THE FINISHED GROUND LEVEL TO REDUCE LITTER BUILD UP
- ALL FIXINGS TO BE HOT DIPPED GALVANISED